



OTIIMA

MUCH MORE THAN A WINDOW





P 8 P HOUSE | ALUMILUX | CABO DEL ARCO | © MARC TORRA



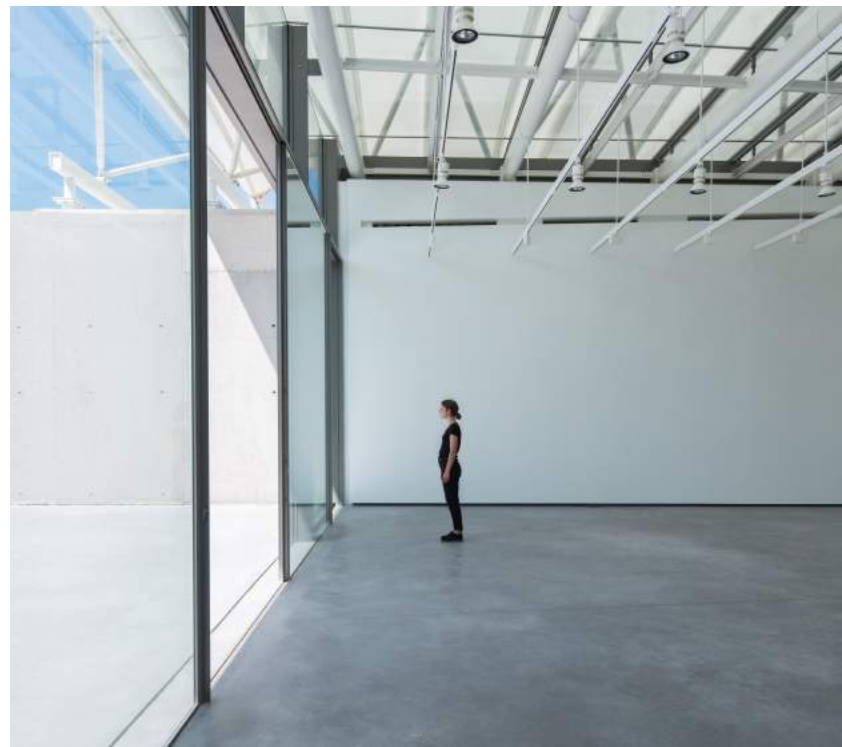











CASA S | ALUMILUX | MARC RIBAS | © CARLES SÁNCHEZ













GERÊS HOUSE | ECOSTEEL | CARLVALHO ARAÚJO | @JUAN RODRIGUEZ | FEATURED ON NETFLIX: "THE WORLDS MOST EXTRAORDINARY HOMES, PORTUGAL



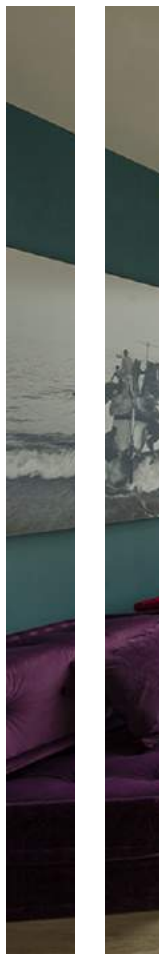

VILLA NEGRA | ALUMILUX | XAVIER MIQUEL MARCER | © GAEEL DEL RIO



José Maria Ferreira | OTIIMA Founder and CEO

The Man Behind the Product

Born and raised in the city of Porto, José Maria Ferreira is a Portuguese, professional businessman with a background in engineering, architecture and design.

Known for his visionary spirit, Ferreira is a pioneer in the industry, having founded and managed his own metalworks company for more than 25 years. His experience fortified by his relationships in the industry affords him a unique pedigree, as he understands the critical confluence of research, industrial manufacturing, and design as well as architecture's integration with emerging technologies.

In 2003, Ferreira began his pivotal work with minimal frame systems. His inherent design and business savvy were paramount for the systems' rapid acceptance and subsequent expansion throughout Portugal, Spain, and France. Looking to maximize the products' potential, Ferreira debuted his own first branded system in 2008, which he later sold to concentrate on his affinity for the arts. The next several years saw the world's preeminent architects asking Ferreira to once again take back his rightful place as the lead visionary of the fenestration market. Armed with more than a decade of design, engineering, and manufacturing experience, he proudly introduced OTIIMA - Much more than a Window in 2014, a brand that aligns itself with Ferreira's innovative and artistic nature.



OTIIMA Factory | Portugal





16 CLASSIC

16 CLASSIC



16 CLASSIC is our interior fixed and sliding glass series, offering transformable interior glass partitions to those wish to obtain balance and continuity with the matching 26, 38 and 54 series products. This series is designed to accept 5/8" (16mm) single-pane glass.

The heat-strengthened tempered glass is available in a variety of colors and clarity options allowing for a multitude of choices for your interior glass walls or doors.

Available configurations include fixed windows, all-glass fixed corners and sliding windows/doors (including pockets and corner-opening configurations).

16 CLASSIC Maximum Panel Size:

Fixed Tempered Glass Panels = 126" x 144"

Sliding Glass Panels = 60" x 120"

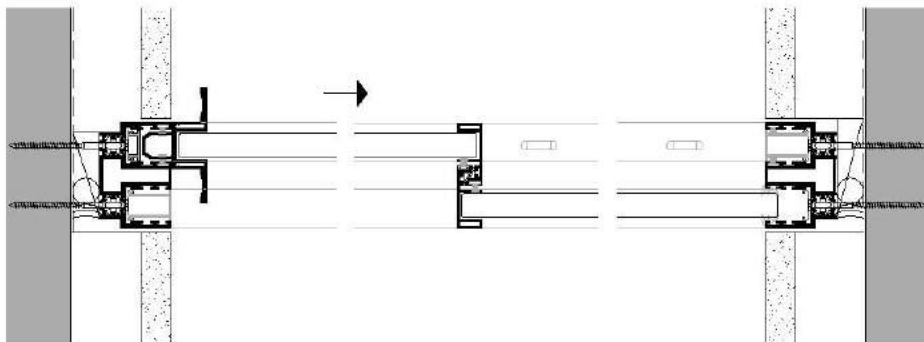

FIXED WINDOWS

One or more panels

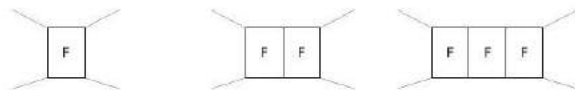

SLIDING PANELS

One or more panels / tracks

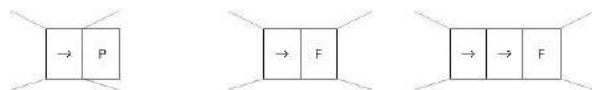

OPEN CORNER SLIDERS

Two or more panels



Four or more tracks and panels available without maximum.

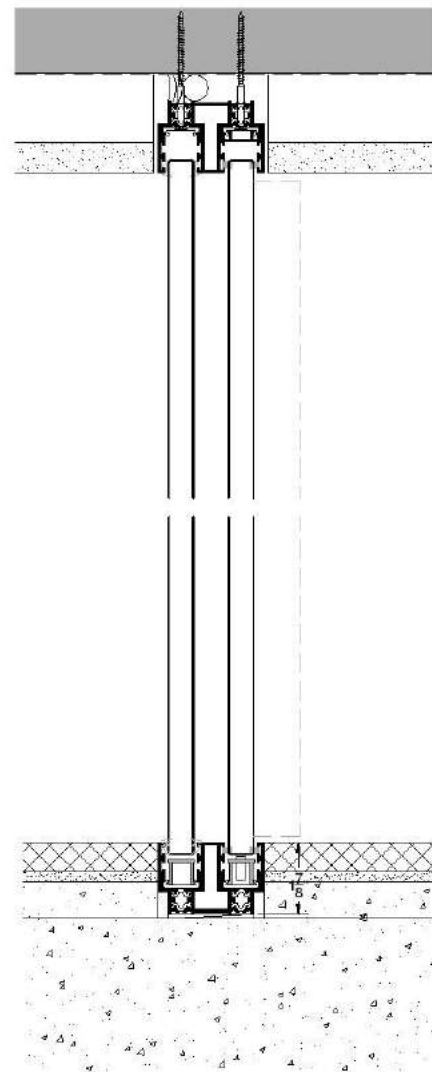



26 PLUS



26 PLUS is ideal for warm climates or projects with reduced thermal requirements. This is a hybrid system with insulated glass and non-insulated monolithic aluminum frames. This system is designed to accept 26mm (1") insulated glass.

Similar to the 38 and 54 series, the 26 PLUS has ultrathin sight lines and can be used as a budget-friendly solution while maintaining the visual impact of the minimal frame design.

Available configurations include fixed windows, multi-panel, sliding windows/doors (including pockets and corner-opening configurations) as well as guillotine windows/doors (ascending/descending panels). Door automation is available with all of our sliding doors.

While the 26 PLUS will be more affordable than our principal 38 and 54 series, there may be limitations on thermal performance and panel size.

26 PLUS Maximum Panel Size:

Fixed Tempered Glass = 126" X 144"

Sliding Glass Panels = 60' X 120"

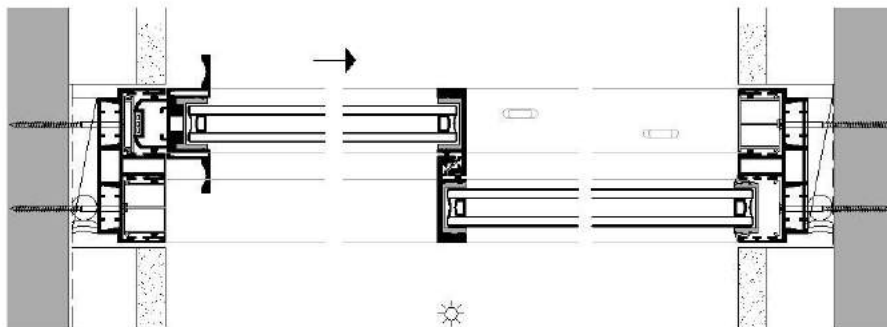

FIXED WINDOWS

One or more panels

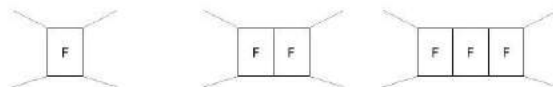

SLIDING PANELS

One or more panels / tracks

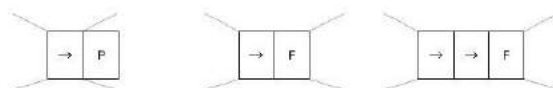

OPEN CORNER SLIDERS

Two or more panels



GUILLOTINE PANELS

One or more panels

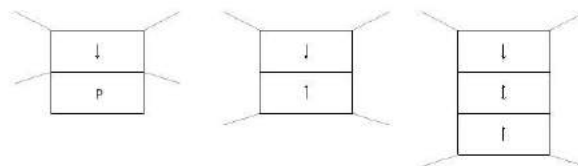

Four or more tracks and panels available without maximum.

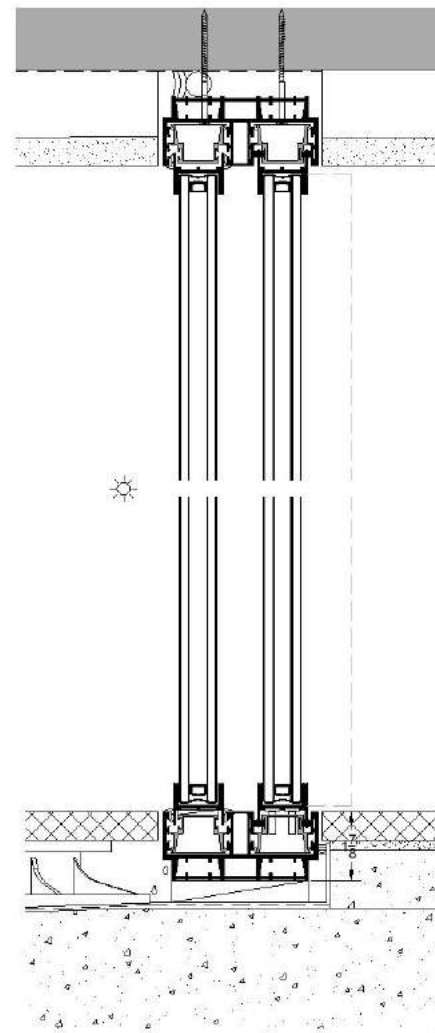



38 SERIES

38 CLASSIC



38 CLASSIC is one of the most popular systems in the lineup of products. Both thermally versatile and structurally robust, it offers the flexibility for use in both warm and moderately cold climates. Designed to accept 38mm (1-1/2") insulated glass, the 38 series can also accommodate triple-pane glass, depending on the thermal demands of the project.

The 38 Series' use of stronger and thicker tempered glass, integrated with the structural components, allows for panel sizes to be much larger than our competitors. Ultrathin sight lines are achieved through three distinct methods: structural glazing, reinforced components and engineered interlocking mullions. OTIMA's framework has been purposely designed for structural integrity while maintaining a minimal visible profile.

Available configurations include fixed windows, multi-panel, sliding windows/doors (including pockets and corner-opening configurations) and guillotine windows/doors (ascending/descending panels). Curved (radius) and sloped/leaning units are also available. Door automation can be integrated with all of our sliding doors.

38 CLASSIC Maximum Panel Size:

Domestic Standard Insulated Glass = 100" x 144"

Domestic Jumbo Insulated Glass = 126" x 268"

European Insulated Glass = 126" x 295"

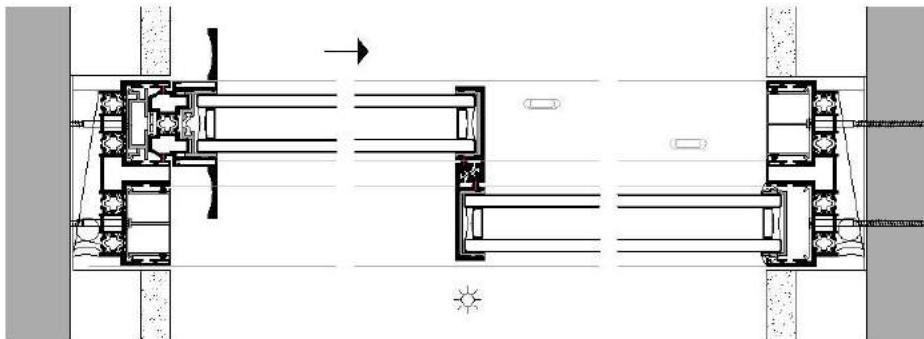

FIXED WINDOWS

One or more panels

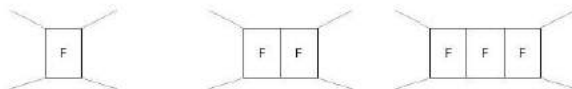

SLIDING PANELS

One or more panels / tracks

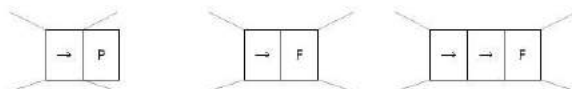

OPEN CORNER SLIDERS

Two or more panels



GUILLOTINE PANELS

One or more panels

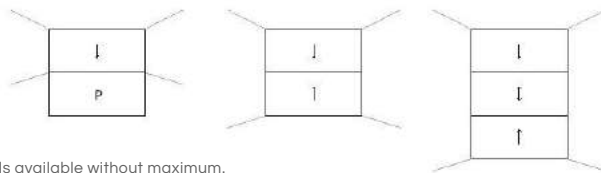

Four or more tracks and panels available without maximum.

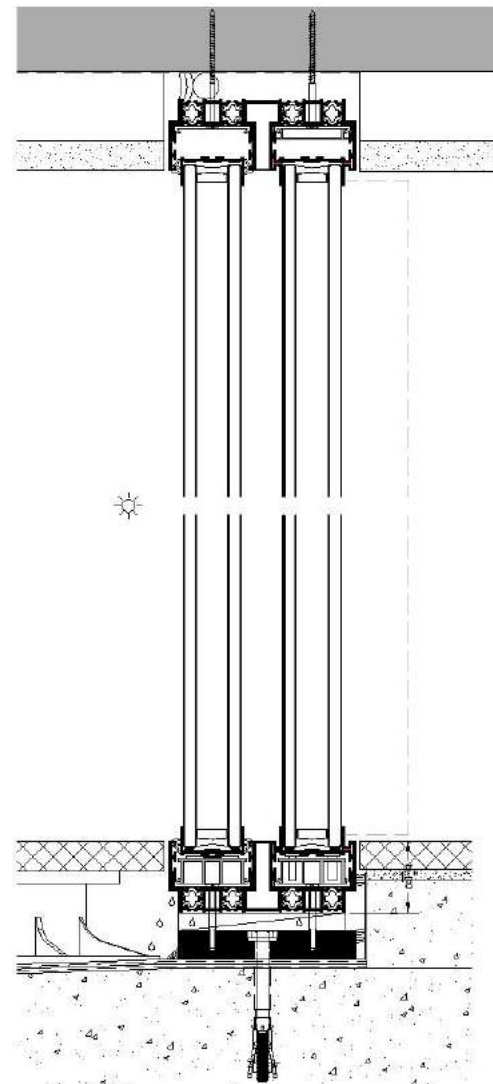

38 GLASSVIEW



38 GLASSVIEW is the product line that offers less exposed metal than our CLASSIC and PLUS lines. In exchange for slightly larger recessed outer frames, it offers a concealed top and bottom rail for a truly flush, aligned and uninterrupted daylight opening.

Both thermally versatile and structurally robust, it offers the flexibility for use in warm and moderately cold climates. It is designed to accept 38mm (1-1/2") insulated glass. The 38 series can also accommodate triple-pane glass, depending on the thermal demands of the project.

Available configurations include fixed windows, multi-panel, sliding windows/doors (including pockets and corner-opening configurations) and curved (radius). Door automation can be integrated with all of our sliding doors.

38 GLASSVIEW Maximum Panel Size:

Domestic Standard Insulated Glass = 100" x 144"

Domestic Jumbo Insulated Glass = 126" x 268"

European Insulated Glass = 126" x 295"

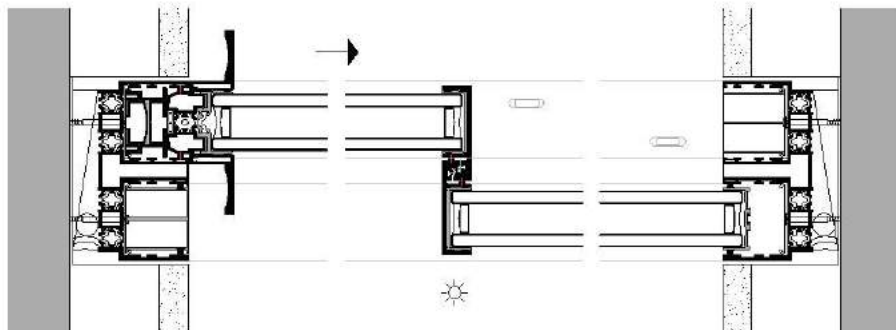

FIXED WINDOWS

One or more panels

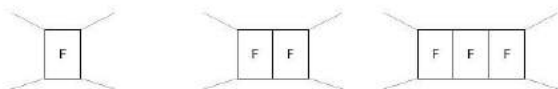

SLIDING PANELS

One or more panels / tracks

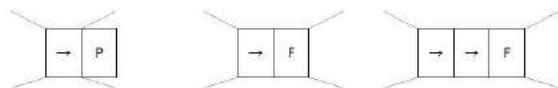

OPEN CORNER SLIDERS

Two or more panels



Four or more tracks and panels available without maximum.

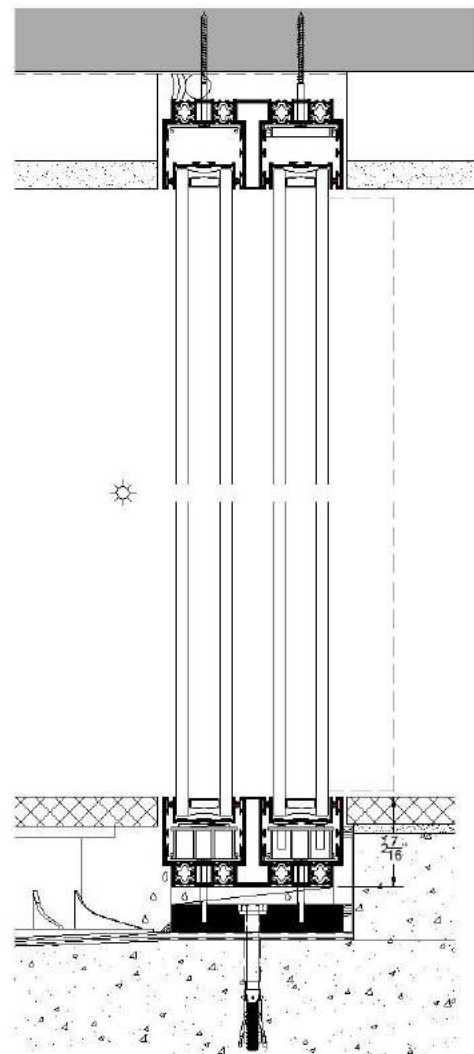



38 PLUS has all of the advantages and versatility of 38 CLASSIC with a small twist in design. Instead of recessed tracks 3/8" (10mm) below the finished floor as required for 38 CLASSIC, 38 PLUS offers a flush head and sill track. Like the 38 CLASSIC, the 38 PLUS is both thermally versatile and structurally robust. It offers the flexibility for use in warm and moderately cold climates. It is designed to accept 38mm (1-1/2") insulated glass. The 38 series can also accommodate triple-pane glass, depending on the thermal demands of the project.

Available configurations include fixed windows, multi-panel, sliding windows/doors (including pockets and corner-opening configurations) and curved (radius). Door automation can be integrated with all of our sliding doors.

38 PLUS Maximum Size:

Domestic Standard Insulated Glass = 100" x 144"

Domestic Jumbo Insulated Glass = 126" x 268"

European Insulated Glass = 126" x 295"

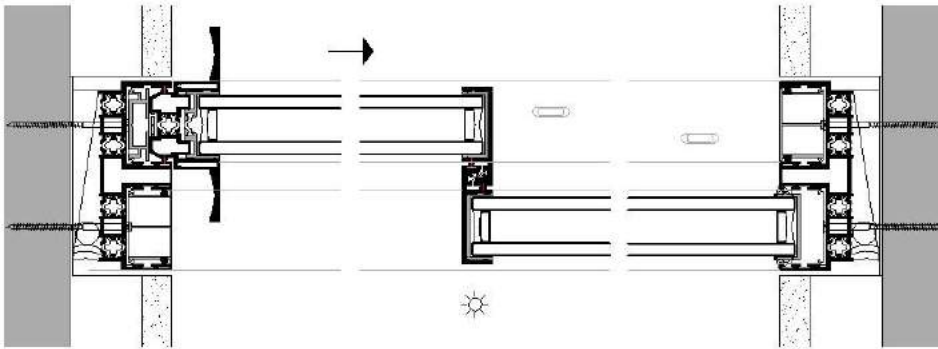

FIXED WINDOWS

One or more panels

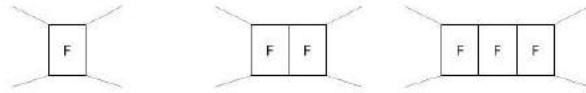

SLIDING PANELS

One or more panels / tracks

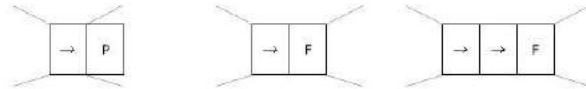

OPEN CORNER SLIDERS

Two or more panels



GUILLOTINE PANELS

One or more panels

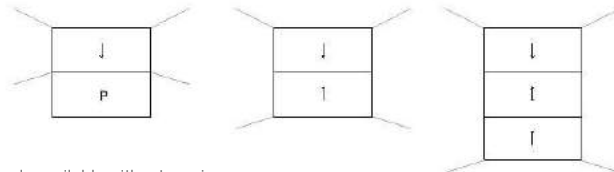

Four or more tracks and panels available without maximum.

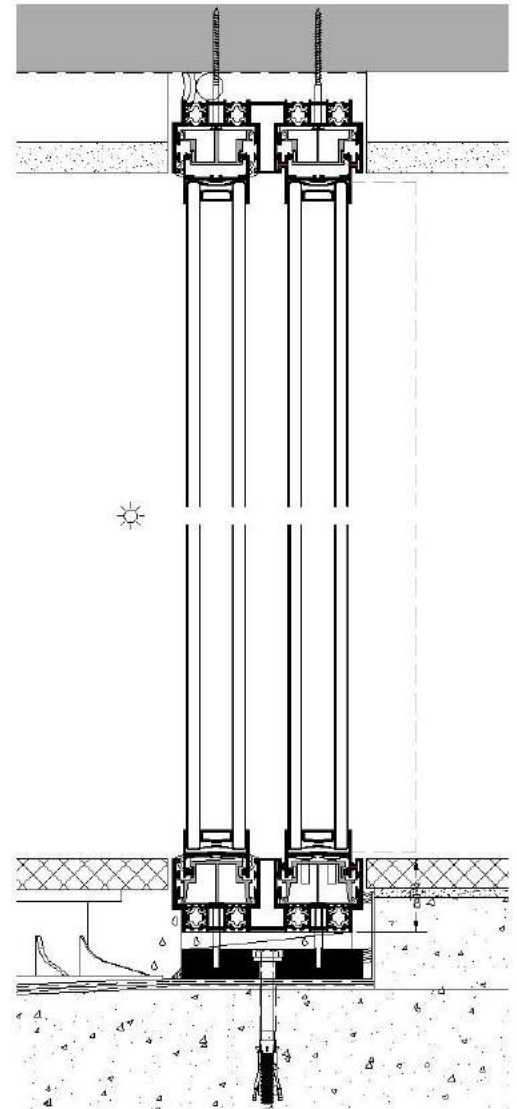

38 SHALLOW



38 SHALLOW is OTIIMA's solution for projects that cannot accommodate our typical 1-7/8" (48mm) tall sill frames. 38 SHALLOW is the ideal choice for renovations and window/door replacement scenarios where minimal floor demolition is essential. Like the 38 CLASSIC, it offers the flexibility for use in warm and moderately cold climates and is designed to accept 38mm (1-1/2") insulated glass.

Available configurations include fixed windows, multi-panel and sliding windows/doors (including pockets and corner-opening configurations). Door automation can be integrated with all of our sliding doors.

38 SHALLOW Maximum Panel Size:

Domestic Standard Insulated Glass = 100" x 144"

Domestic Jumbo Insulated Glass = 126" x 268"

European Insulated Glass = 126" x 295"

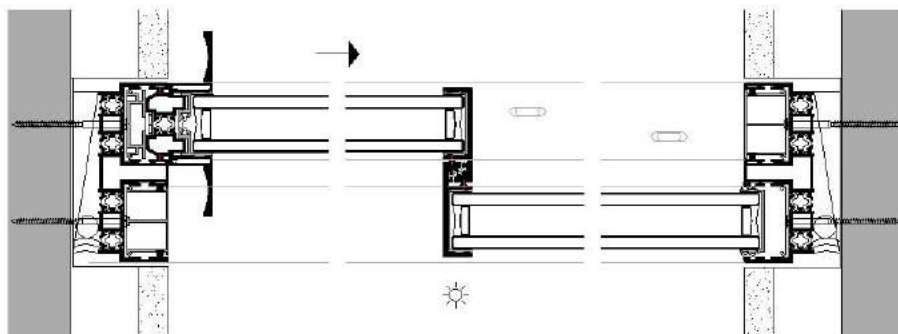

FIXED WINDOWS

One or more panels

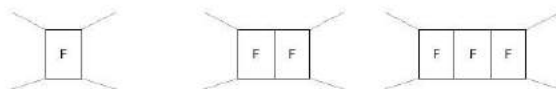

SLIDING PANELS

One or more panels / tracks

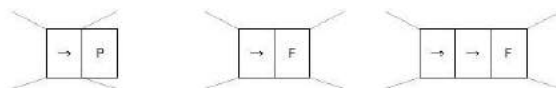

OPEN CORNER SLIDERS

Two or more panels



Four or more tracks and panels available without maximum.

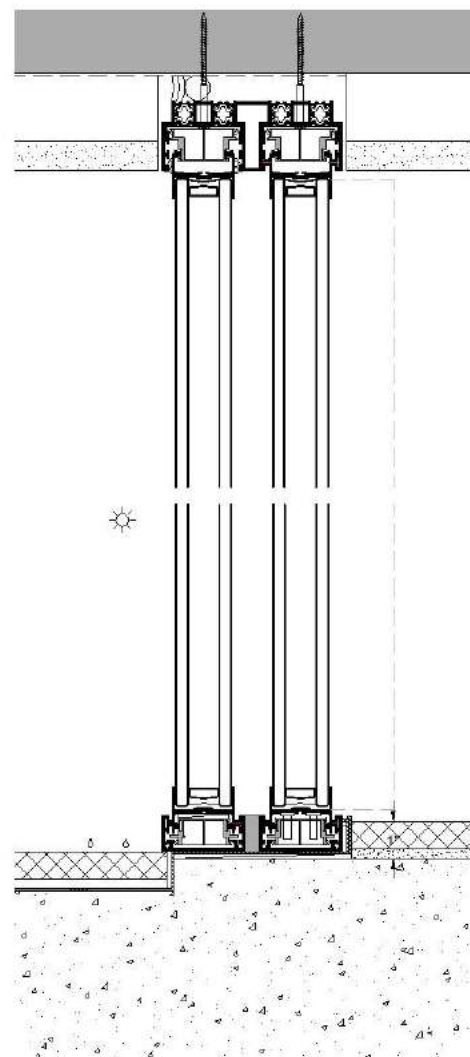

38 DRAIN



38 DRAIN is OTIIMA's hidden sill variant of the 38 Series, with optional hidden sub-frame and trench drain. All of the versatility and flexibility offered in the 38 CLASSIC are combined with an ingenious hidden sill design. Removable finish floor clips offer easy access for future maintenance. OTIIMA's hidden sill design is notable for utilizing a single slot for each track. Some competitor's designs require two slots per panel. It is designed to accept 38mm (1-1/2") insulated glass. The 38 series can also accommodate triple-pane glass, depending on the thermal demands of the project.

Available configurations include fixed windows, multi-panel and sliding windows/doors (including pockets and corner-opening configurations). Door automation can be integrated with all of our sliding doors.

38 DRAIN Maximum Panel Size:

Domestic Standard Insulated Glass = 100" x 144"

Domestic Jumbo Insulated Glass = 126" x 268"

European Insulated Glass = 126" x 295"

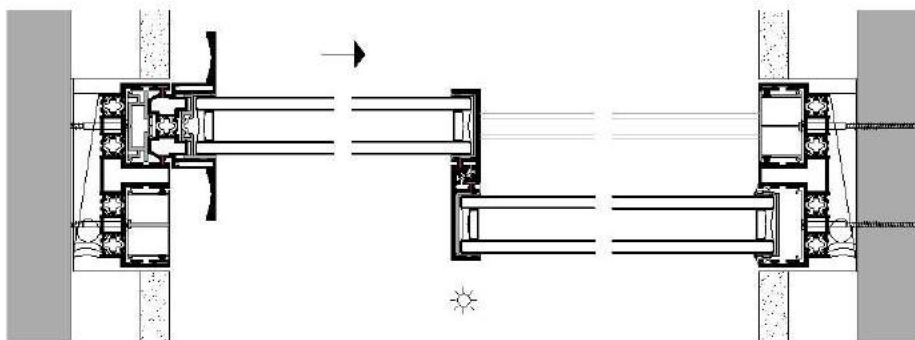

FIXED WINDOWS

One or more panels

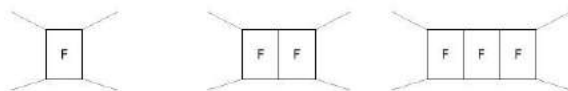

SLIDING PANELS

One or more panels / tracks

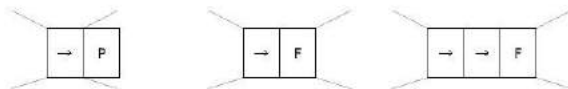

OPEN CORNER SLIDERS

Two or more panels



38 DRAIN

Complete with gutter and sub-frame (right)

Without gutter and sub-frame (center)

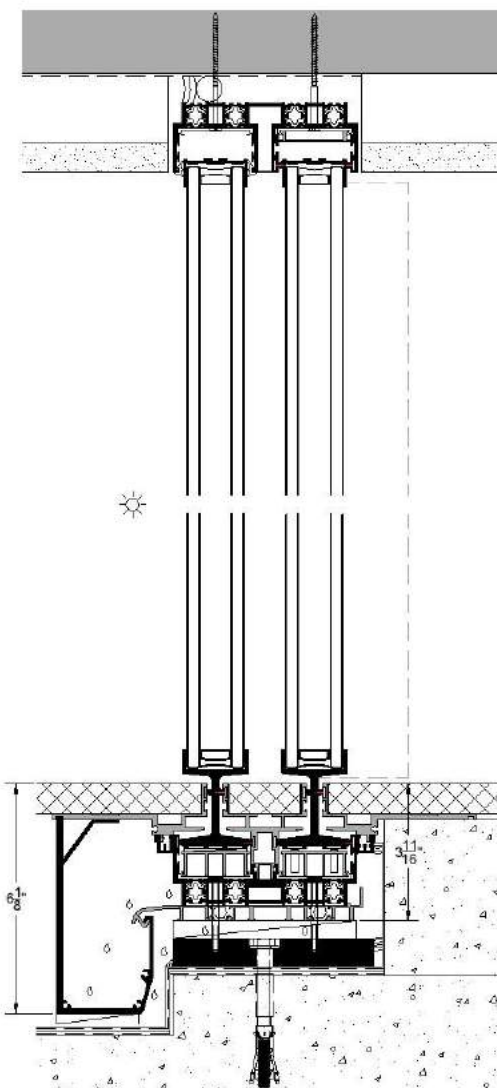
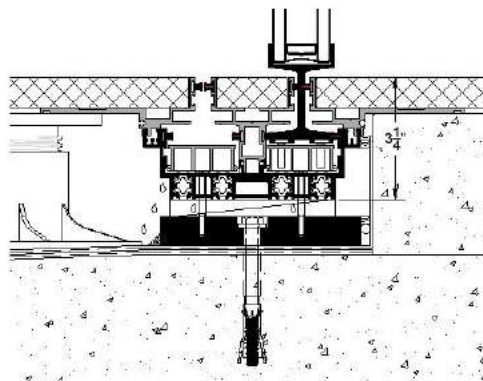

38 FUSION

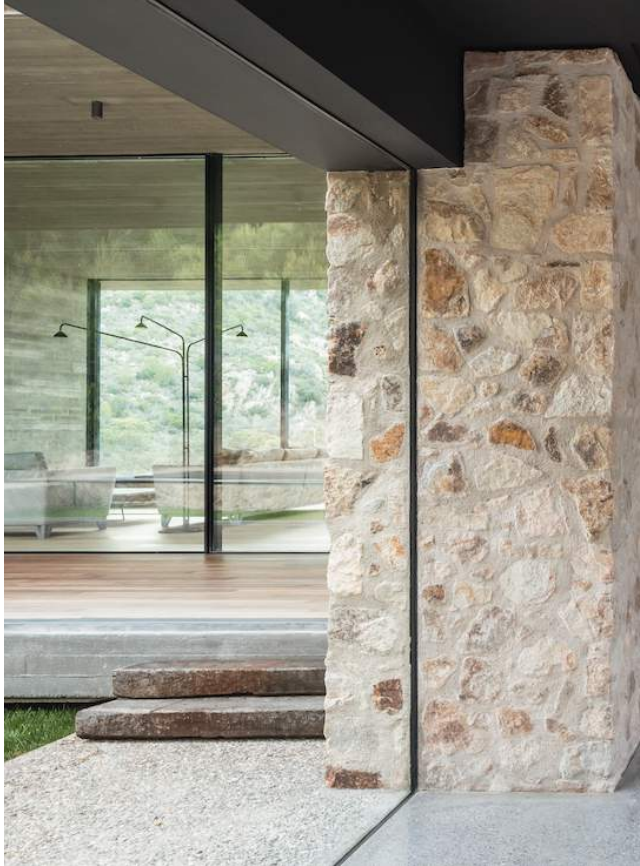

38 FUSION represents the latest evolution of OTIIMA's sliding door platform, offering: hidden header, sill and jamb frames. Our FUSION series demonstrates our drive to develop game-changing design capabilities for the architectural community.

The FUSION's exclusive design features a completely redefined, minimalistic frame system by providing the appearance of "floating" glass door panels within the architectural finishes. Created to accept 38mm (1-1/2") insulated glass. The 38 series can also accommodate triple-pane glass, depending on the thermal demands of the project.

OTIIMA is the only company in the world to offer this award-winning system.

Available configurations include fixed windows, multi-panel and sliding windows/doors (including pockets and corner-opening configurations). Door automation can be integrated with all of our sliding doors.

38 FUSION Maximum Panel Size:

Domestic Standard Insulated Glass = 100" x 144"

Domestic Jumbo Insulated Glass = 126" x 268"

European Insulated Glass = 126" x 295"

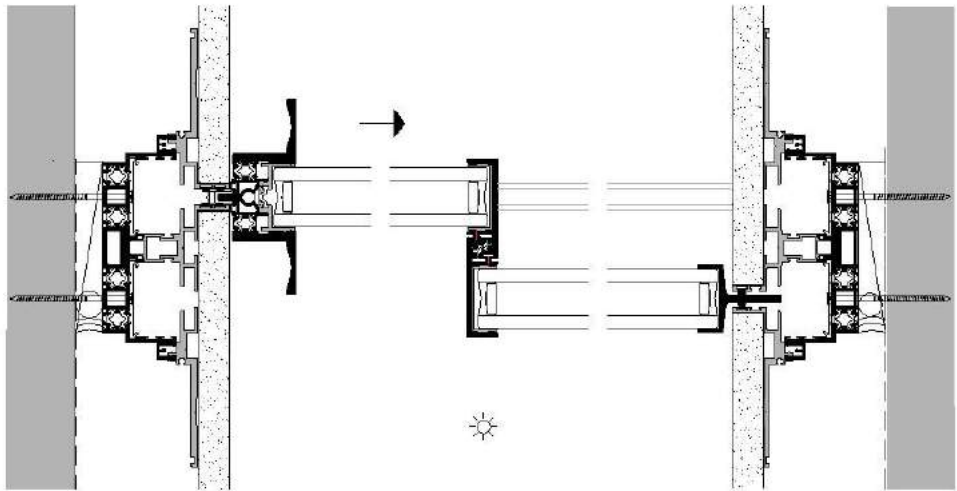

38 FUSION

Complete with gutter and sub-frame (right)

Without gutter and sub-frame (center)

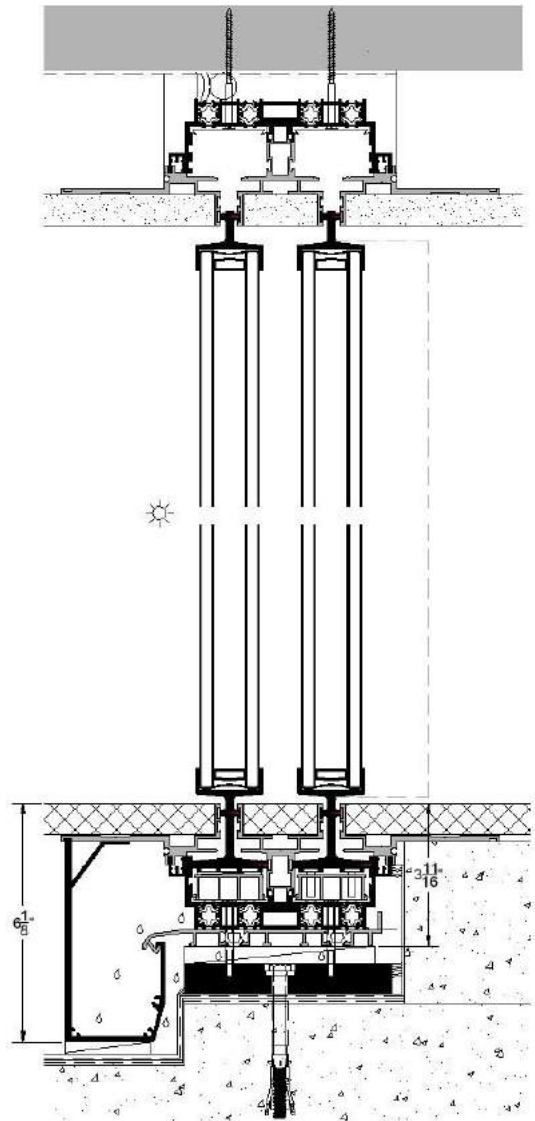
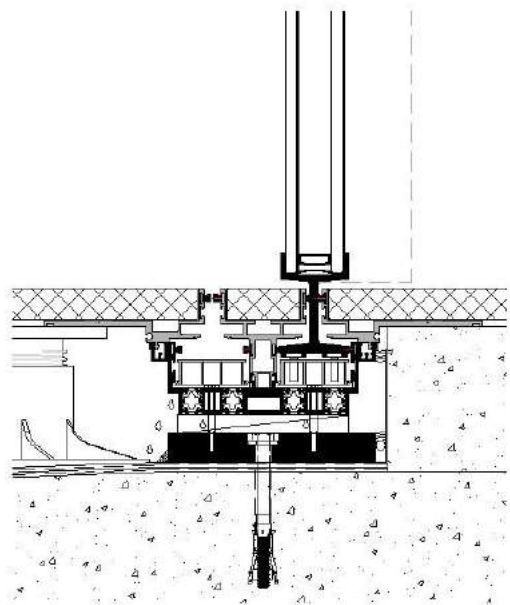

38 GUILLOTINE



38 GUILLOTINE is OTIIMA's vertical sliding window system that uses hidden counter-weights and pulleys to balance the mass of the operable panels. It is offered in one or more panels, one or more tracks and can be operated manually or motorized.

Ascending or descending panels can be configured with fixed panels or vertical pocketing conditions.

Available configurations include fixed windows, multi-panel and sliding windows/doors (including pocket configurations).

38 GUILLOTINE Maximum Size:

Domestic Standard Insulated Glass = 100" x 144"

Domestic Jumbo Insulated Glass = 126" x 268"

European Insulated Glass = 126" x 295"

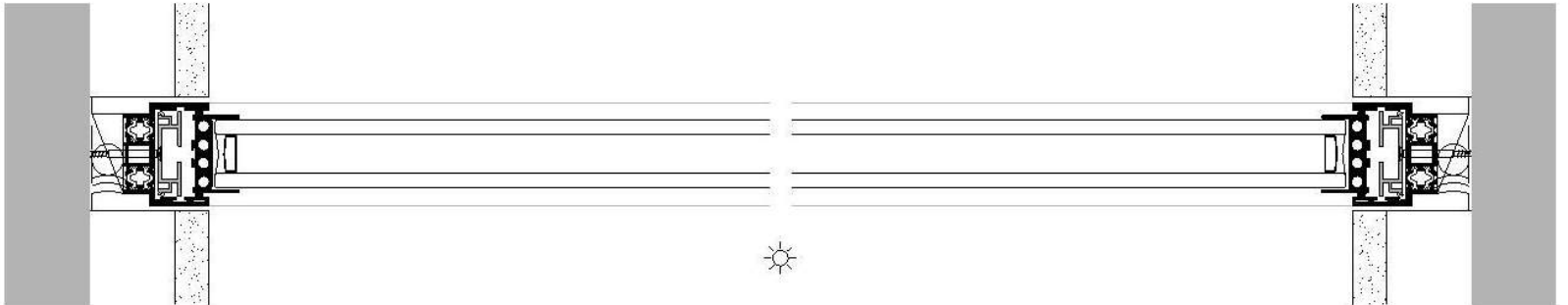
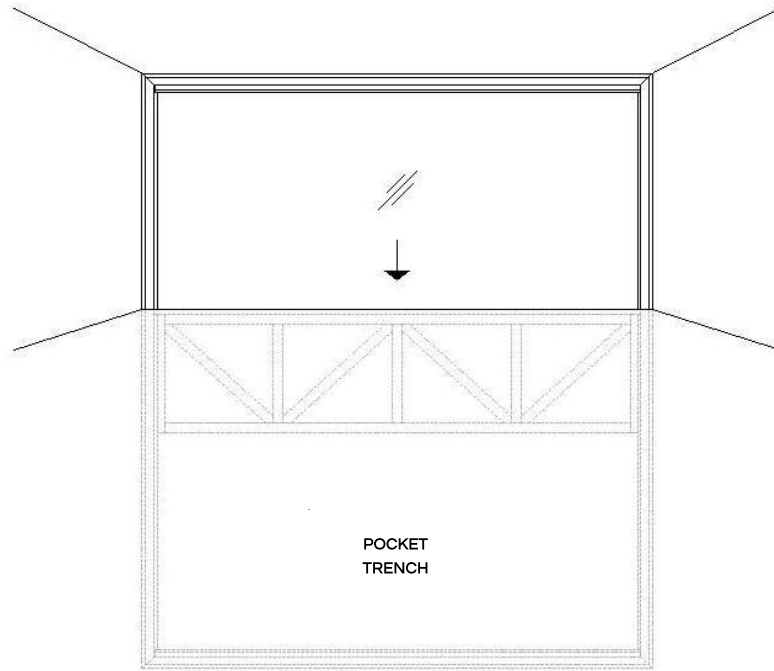

38 DESCENDING DOOR

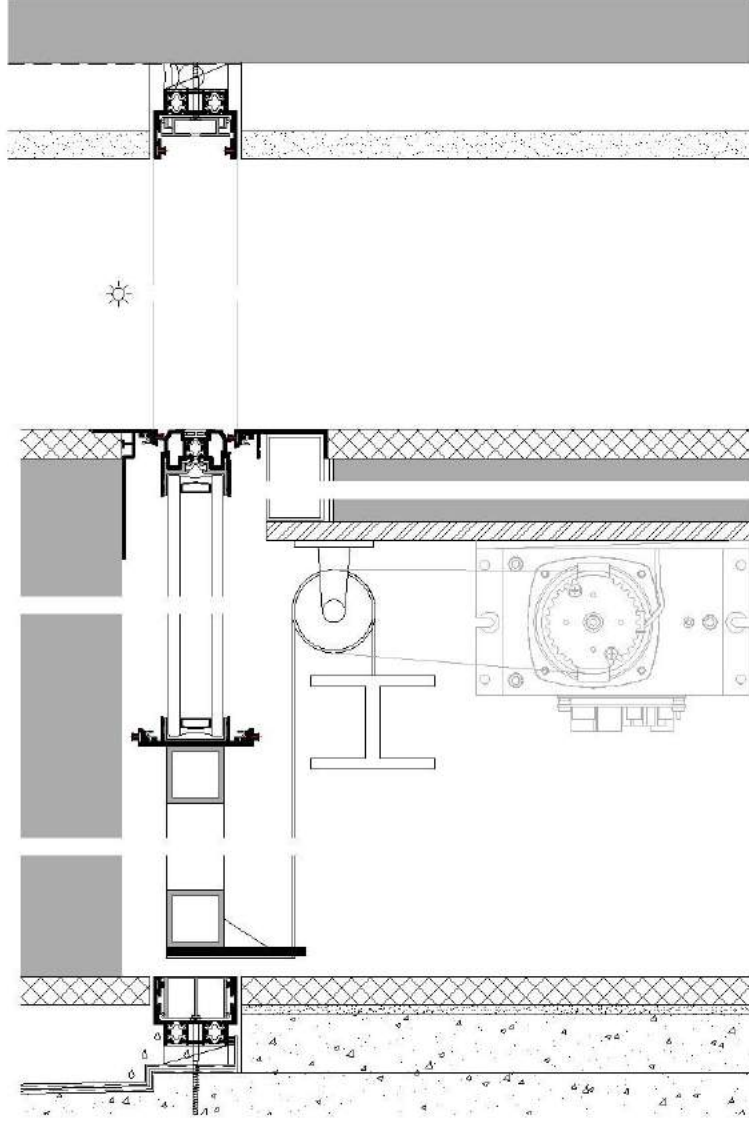
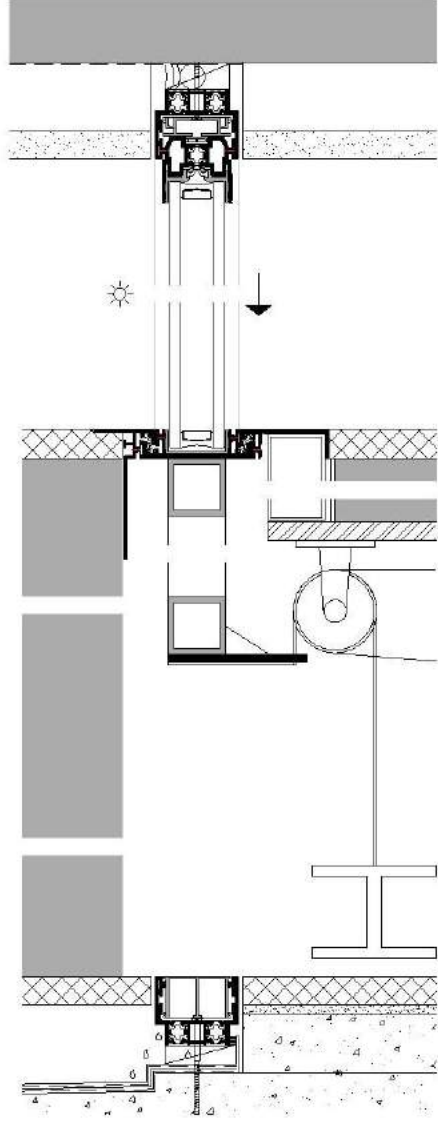

38 ASCENDING DOOR

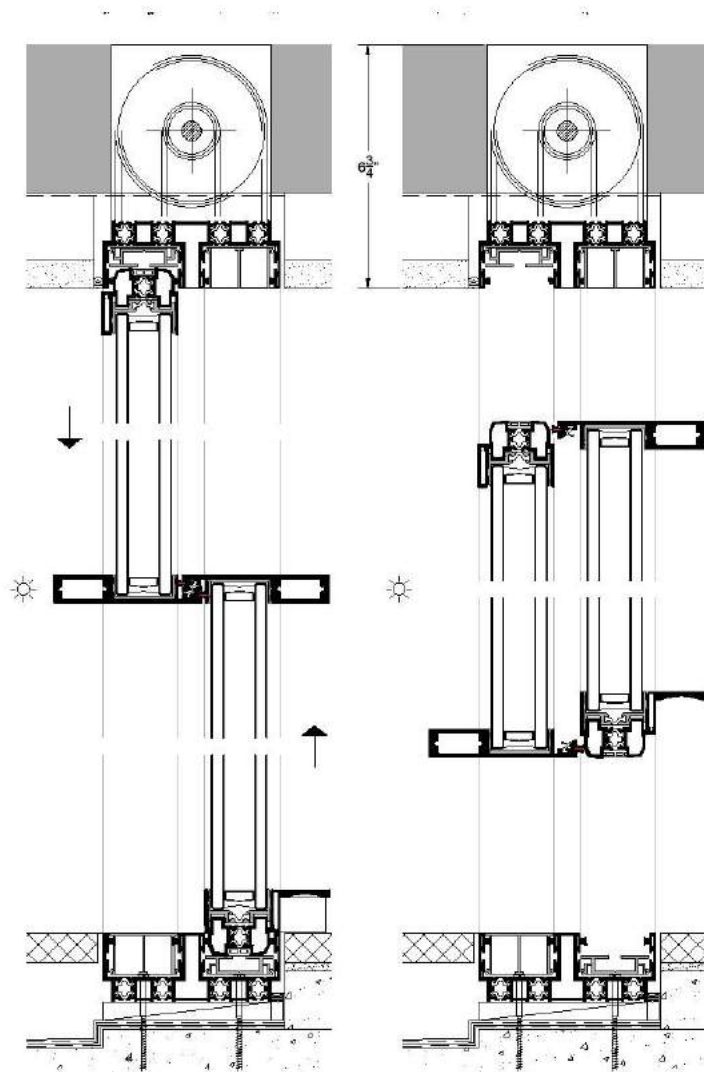
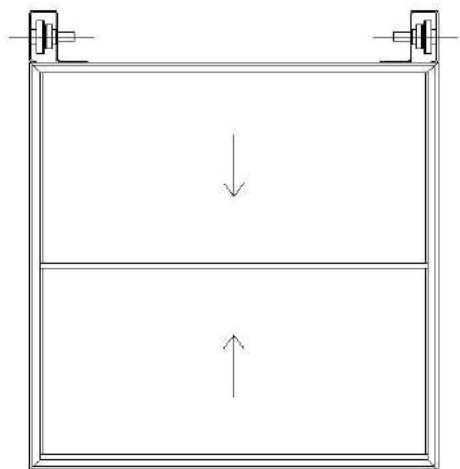
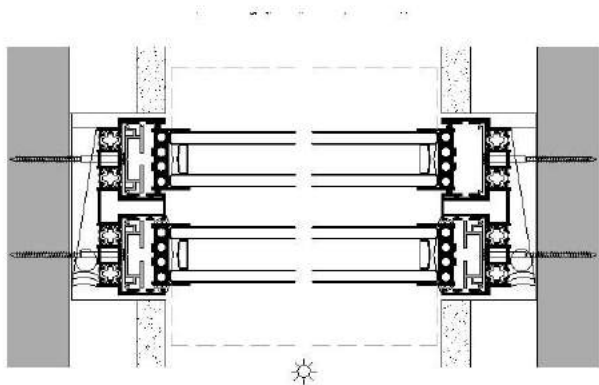

CLOSED POSITION

OPEN POSITION

38 PIVOT



38 PIVOT offers clients a more broad range of operable door types. Often used as an entry door or a wall of doors. It is created to accept 38mm (1-1/2") insulated glass. The 38 series can also accommodate triple-pane glass, depending on the thermal demands of the project.

Available configurations include single and multi-panel, inward/outward opening and manually operated or automated pivot doors. Each door type can be mulled to fixed windows or window-walls for facade applications.

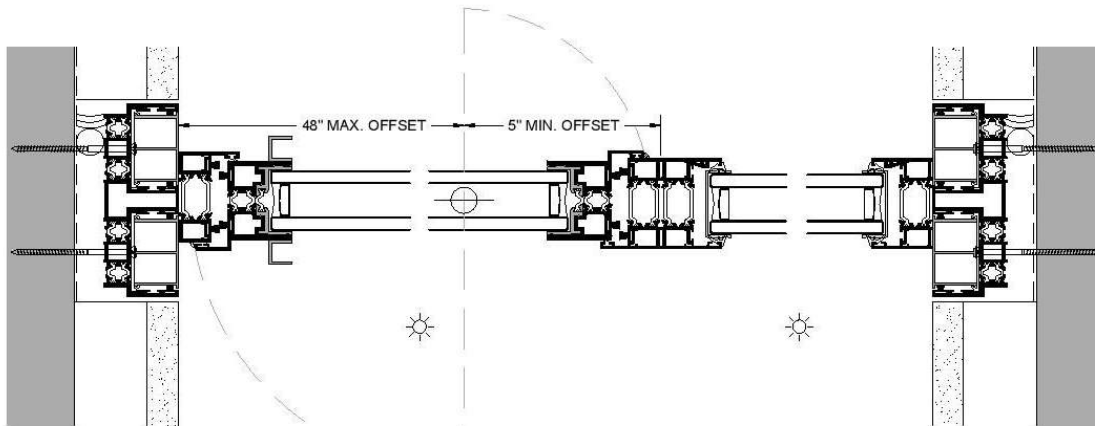

ELECTRONIC LOCKING STILE
Magnetic Lock (12/24VDC)

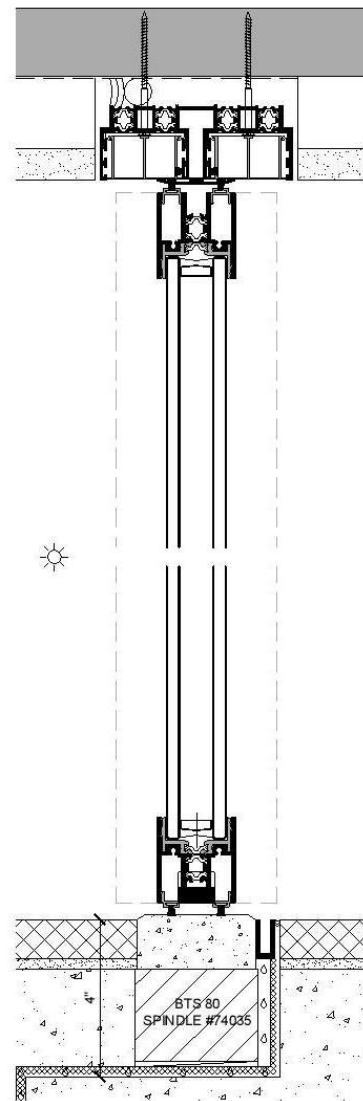

PIVOT

MANUAL LOCKING
Keyed Lock to Exterior
+ Thumb-Turn

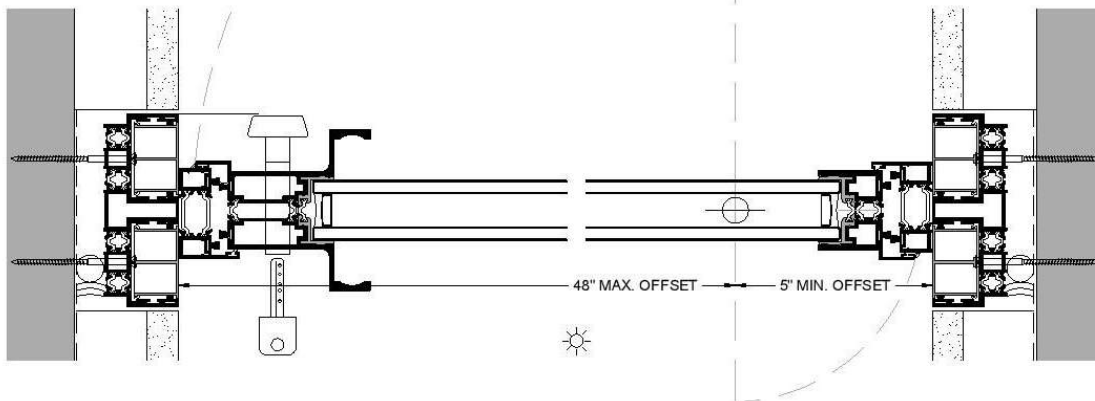

38 SWING



38 SWING is a swing door product with concealed hinges. Offered in inswing and outswing configurations, this system is most suitable for entry and patio doors. It is designed to accept 38mm (1-1/2") insulated glass. The 38 SWING can also accommodate triple-pane glass, depending on the thermal demands of the project.

The 38 SWING is available with fixed sidelights or transoms and includes a keyed entry (or thumb-turn only) lock when used with our wider stile design. A narrow stile is available when using an electromagnetic lock.

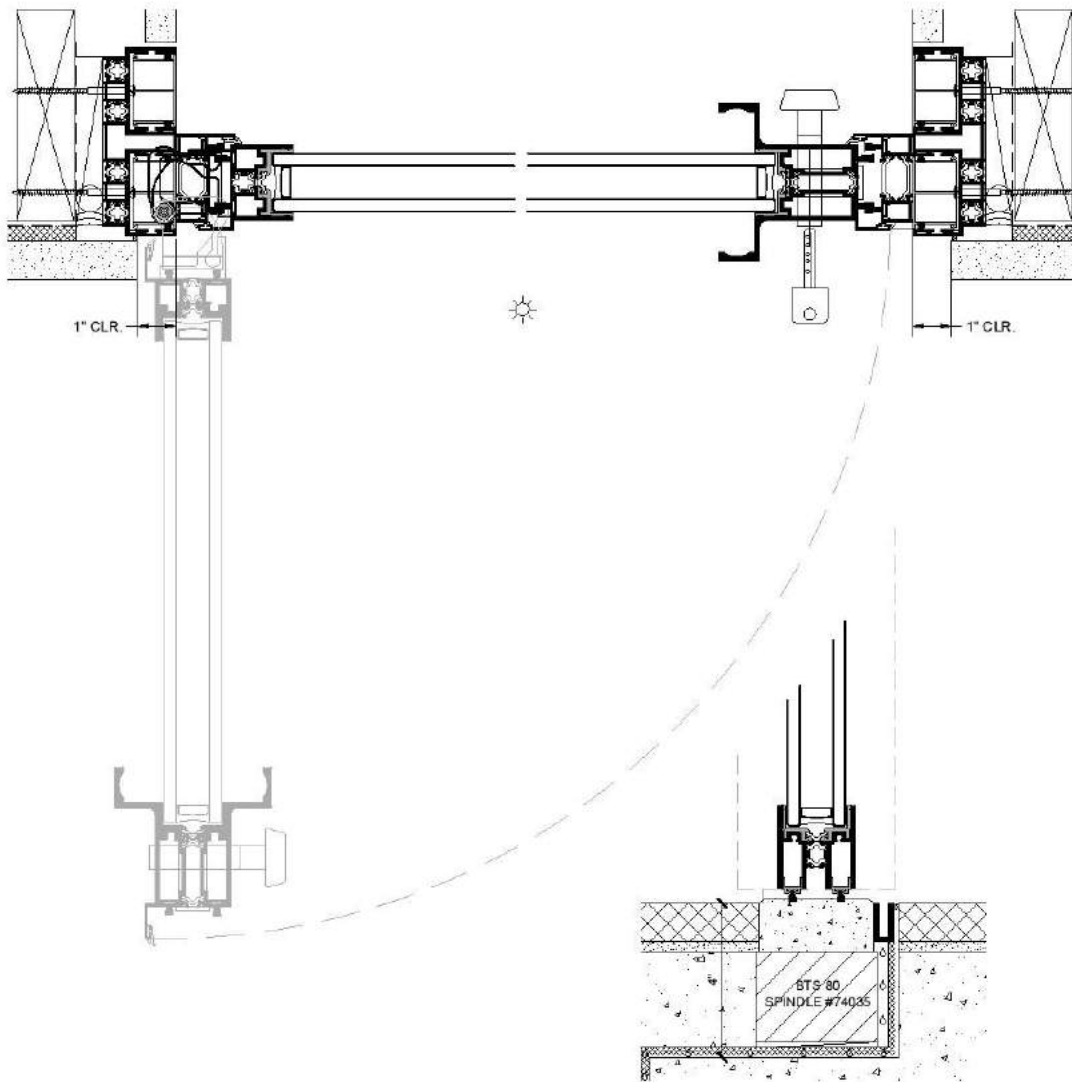

MINIMAL SILL + DRAIN CHANNEL

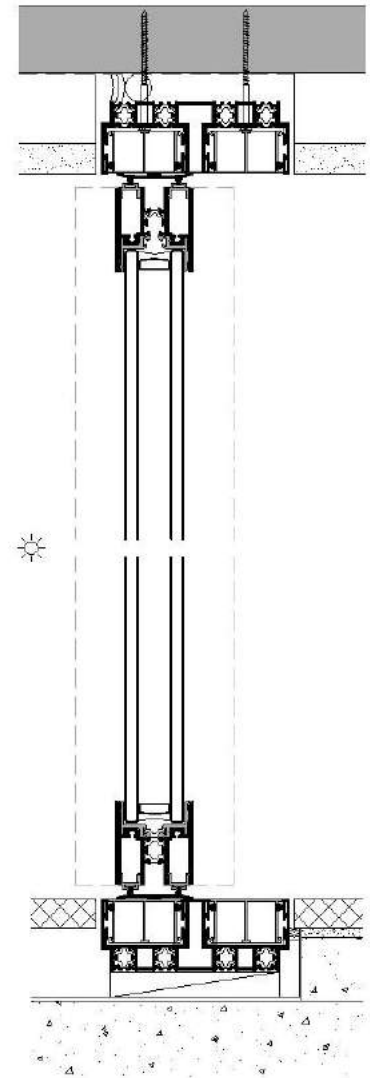

STANDARD SWING DOOR SILL

38 SERIES WINDOWS



38 OPEN is OTIIMA's operable window system offered in both inward and outward opening configurations. It is designed to accept 38mm (1-1/2") insulated glass for moderate climates and offers multi-point locking for increased security. Concealed motorization available upon request.

Available configurations include inward-opening hopper, tilt and turn windows (dual functionality) and outward-opening awning or casement windows. Each window type can be mulled to fixed windows, other venting windows or window-walls for facade applications. Curved (radius) and sloped/leaning units are also available upon request.

38 INSWING WINDOWS

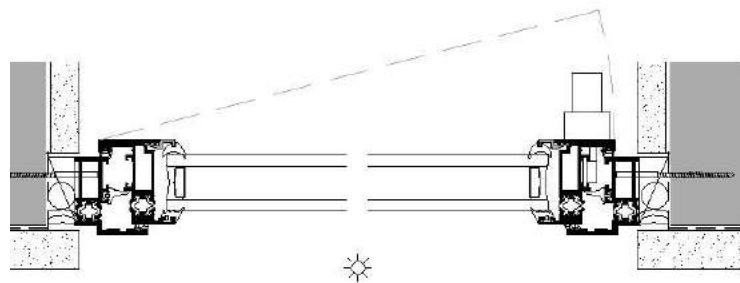
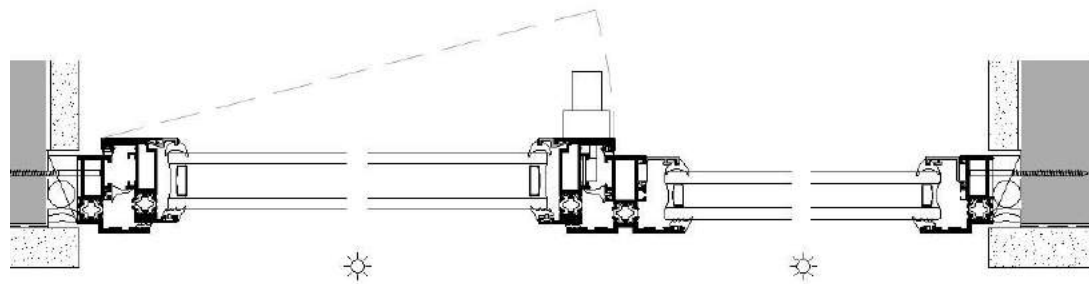

HOPPER WINDOWS

Inward Tilt Windows
and Fixed / Tilt Combos

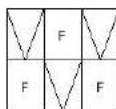
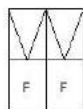
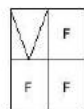
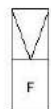
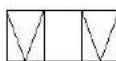

TILT/TURN WINDOWS

Inward Tilt/Swing Windows
and Fixed / Tilt/ Swing

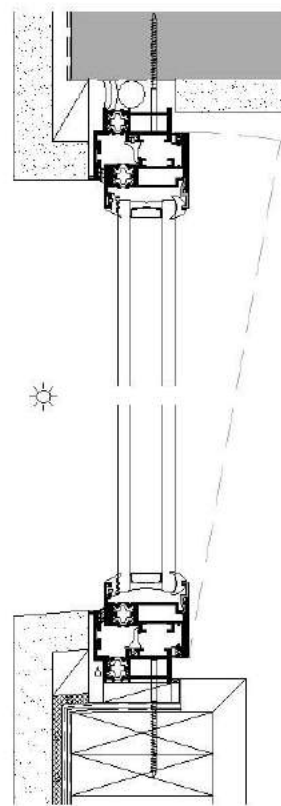
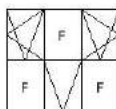
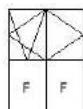
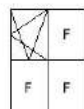
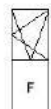

TILT/TURN & HOPPER

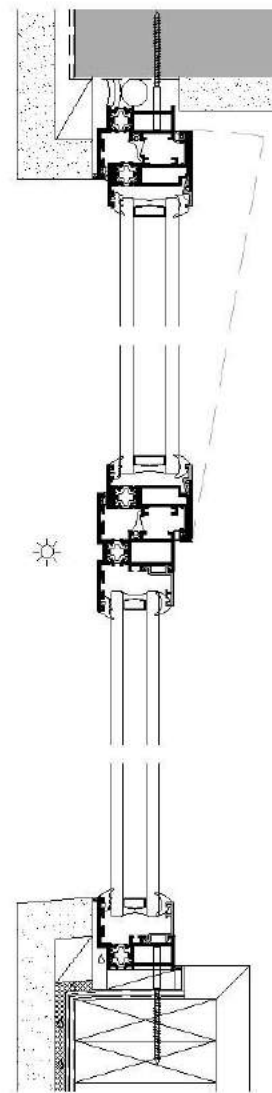

TILT/TURN OVER FIXED

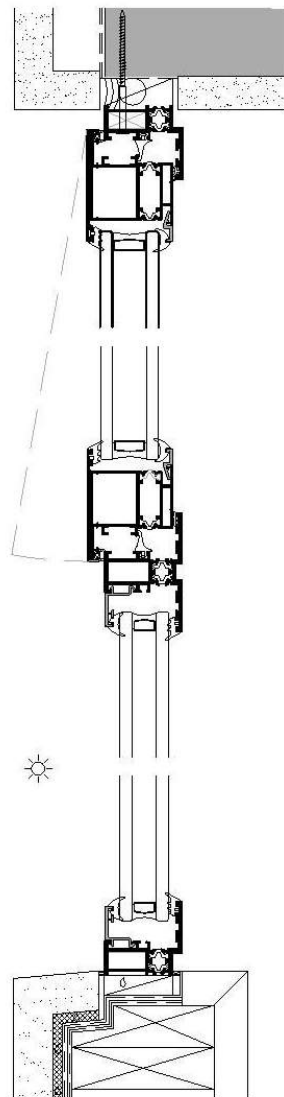
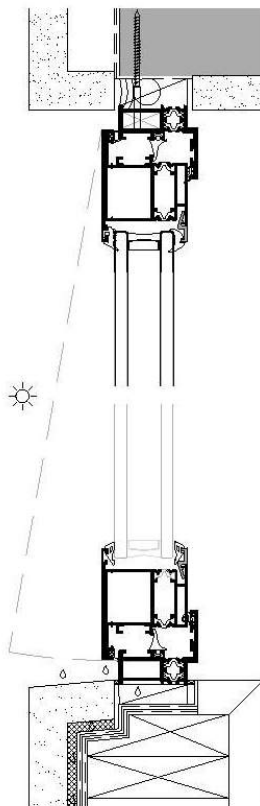
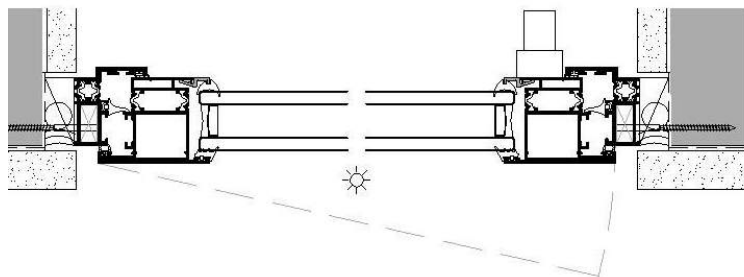
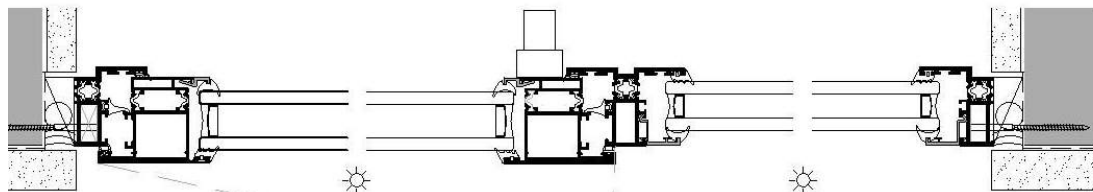

AWNING WINDOWS

+ Fixed Sidelights
Outswing Only

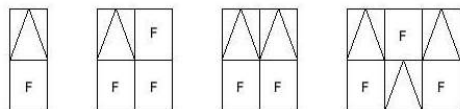

CASEMENT WINDOWS

+ Fixed Sidelights
Outswing Only

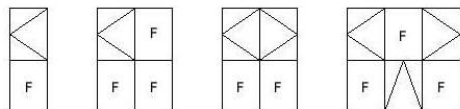



38 FIXED is OTIIMA's picture window fixed glazing system. This series allows for both interior and exterior glazing options. The FIXED offers a choice of traditional coplanar glass panels with 1-9/16" (40mm) mullions or staggered alternating-plane panels with 13/16" (20mm) mullions.

By utilizing the same framework as our door systems, the FIXED has glass sight lines that perfectly match those of OTIIMA's sliding doors.

Both thermally versatile and structurally robust, 38 FIXED offers the flexibility for use in warm and moderately cold climates. It is designed to accept 38mm (1-1/2") insulated glass. The 38 series can also accommodate triple-pane glass, depending on the thermal demands of the project.

Curved (radius) and sloped/leaning facades are available upon request.

38 FIXED Maximum Panel Size:

Domestic Standard Insulated Glass = 100" x 144"

Domestic Jumbo Insulated Glass = 126" x 268"

European Insulated Glass = 126" x 295"

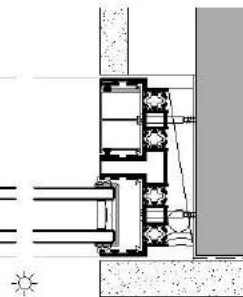
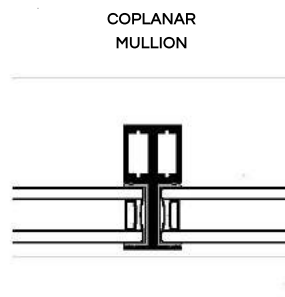
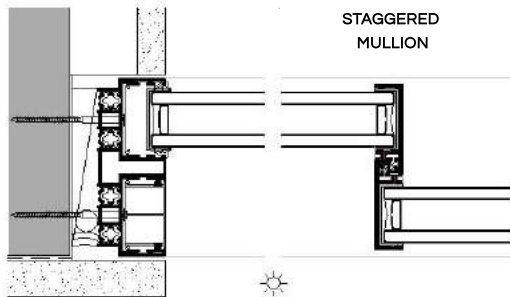
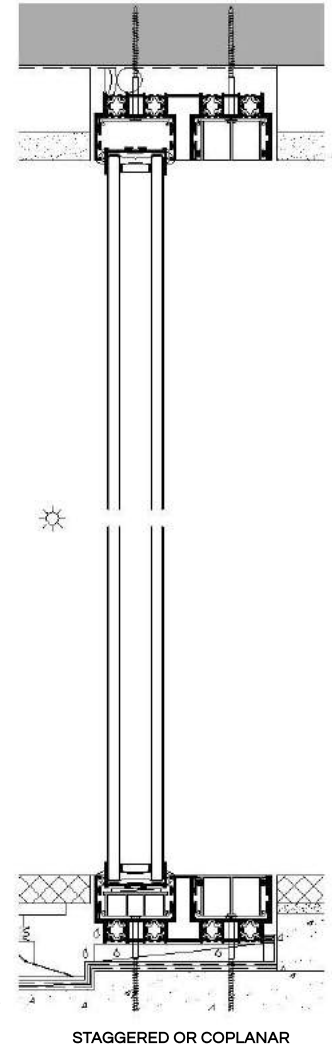
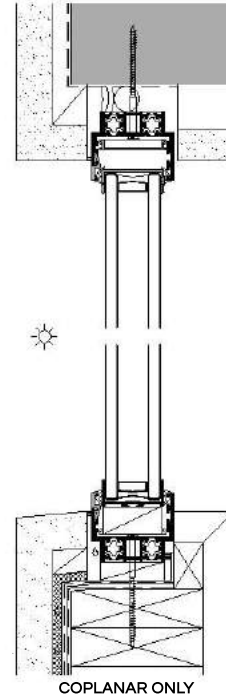
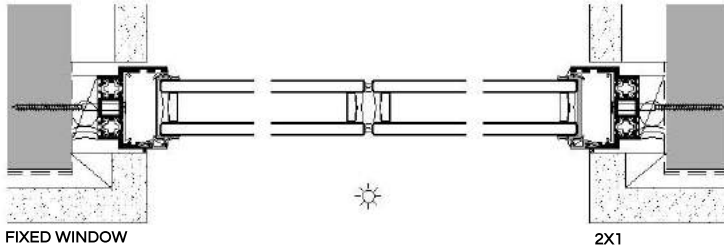
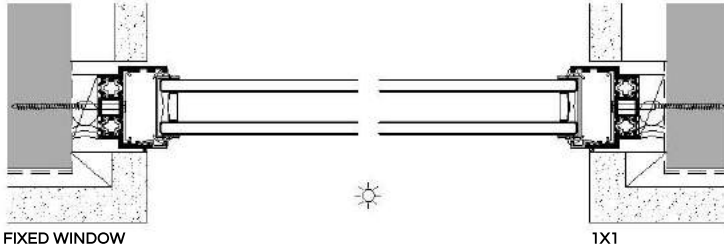



54 SERIES

54 CLASSIC



54 CLASSIC is similar in appearance to our 38 Series options, but it is specifically designed for cold climates. It is optimized for 54mm (2-1/8") triple-pane insulated glass. The 54 Series can accommodate oversized "jumbo" double-pane glass. Multiple laminated glass options are available when noise reduction and/or impact performance is desired.

The 54 Series' use of stronger and thicker tempered glass, integrated with the structural components, allows for panel sizes to be much larger than our competitors. Ultrathin sight lines are achieved through three distinct methods: structural glazing, reinforced components and engineered interlocking mullions. OTIIMA's framework has been purposely designed for structural integrity while maintaining a minimal visible profile.

Available configurations include fixed windows, multi-panel and sliding windows/doors (including pockets and corner-opening configurations). Door automation can be integrated with all of our sliding doors.

54 CLASSIC Maximum Panel Size:

Domestic Standard Insulated Glass = 100" x 144"

Domestic Jumbo Insulated Glass = 126" x 268"

European Insulated Glass = 126" x 295"

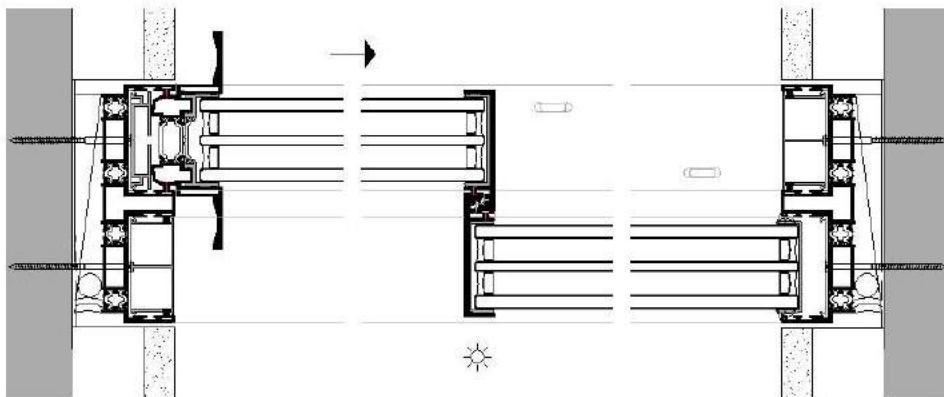

FIXED WINDOWS

One or more panels

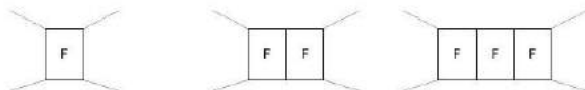

SLIDING PANELS

One or more panels / tracks

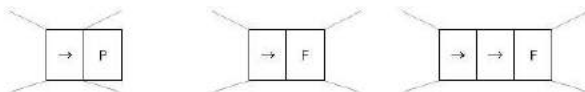

OPEN CORNER SLIDERS

Two or more panels



GUILLOTINE PANELS

One or more panels

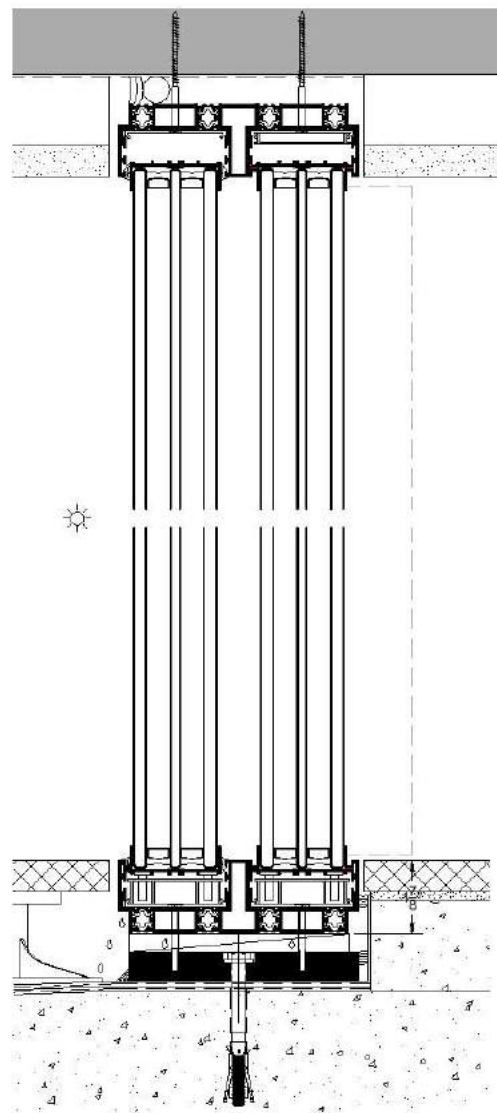
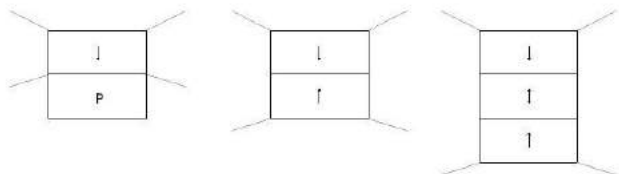



54 PLUS takes all of the advantages and versatility of 54 CLASSIC and takes it one step further. Instead of recessed tracks 3/8" (10mm) below the finished floor, as required for 54 CLASSIC, 54 PLUS offers a flush head and sill track.

This system is specifically designed for cold climates. It is optimized for 54mm (2-1/8") triple-pane insulated glass. The 54 Series can accommodate oversized "jumbo" double-pane glass. Multiple laminated glass options are available when noise reduction and/or impact performance is desired.

Available configurations include fixed windows, multi-panel and sliding windows/doors (including pockets and corner-opening configurations) and guillotine (ascending and descending panels). Door automation can be integrated with all of our sliding doors.

54 PLUS Maximum Panel Size:

Domestic Standard Insulated Glass = 100" x 144"

Domestic Jumbo Insulated Glass = 126" x 268"

European Insulated Glass = 126" x 295"

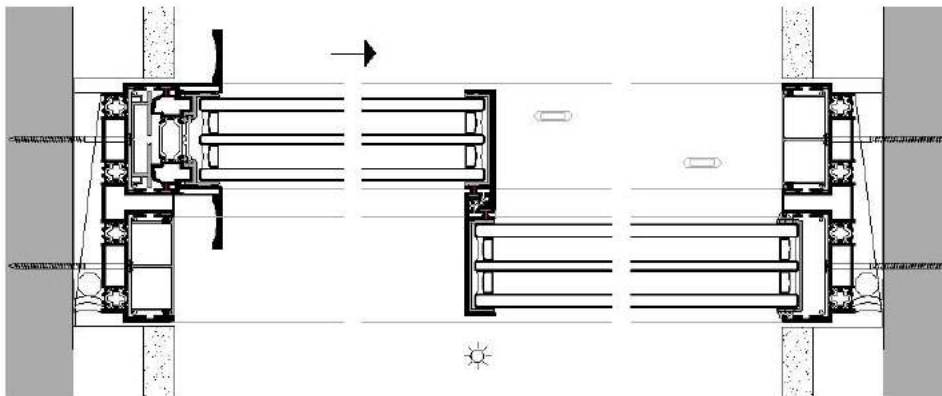

FIXED WINDOWS

One or more panels

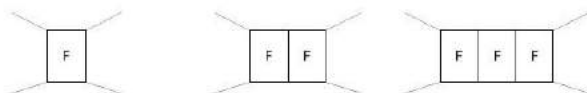

SLIDING PANELS

One or more panels / tracks

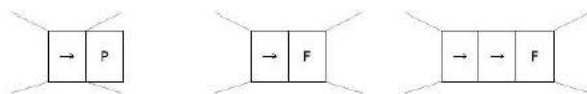

OPEN CORNER SLIDERS

Two or more panels



GUILLOTINE PANELS

One or more panels

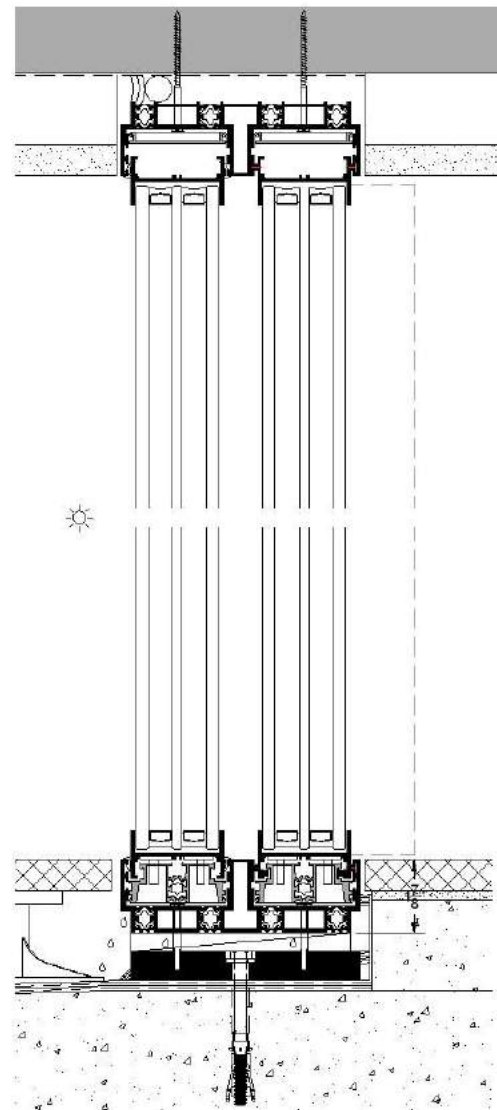
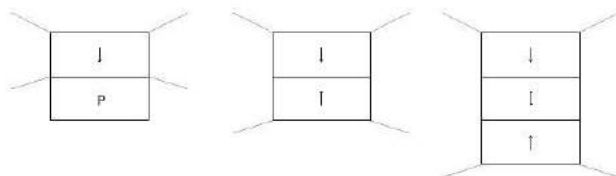

54 DRAIN



54 DRAIN offers all of the versatility and flexibility of the 54 CLASSIC with an ingenious hidden sill design. Removable finish floor clips allows easy access for future maintenance. OTIIMA's hidden sill design is notable for utilizing a single slot for each track. Some competitor's designs require two slots per panel. The 54 Series is specifically designed for cold climates by utilizing 54mm (2-1/8") triple-pane insulated glass. The 54 Series can accommodate oversized "jumbo" double-pane glass. Multiple laminated glass options are available when noise reduction and/or impact performance is desired.

Available configurations include fixed windows, multi-panel and sliding windows/doors (including pockets and corner-opening configurations). Door automation can be integrated with all of our sliding doors.

54 DRAIN Maximum Panel Size:

Domestic Standard Insulated Glass = 100" x 144"

Domestic Jumbo Insulated Glass = 126" x 268"

European Insulated Glass = 126" x 295"

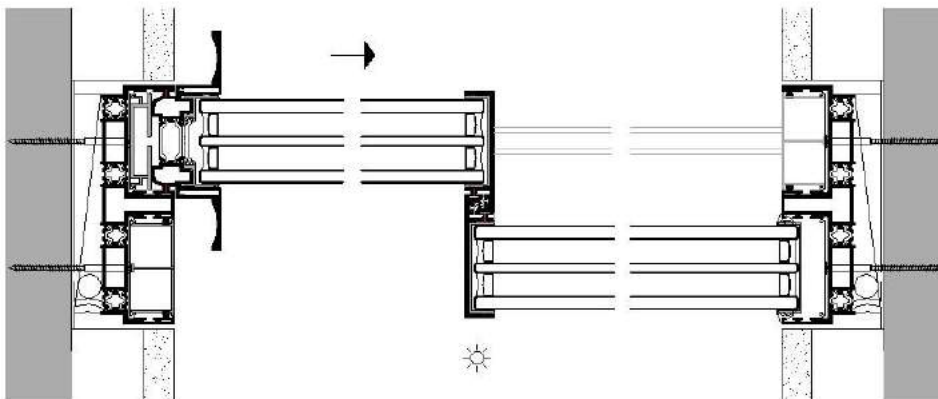

FIXED WINDOWS

One or more panels

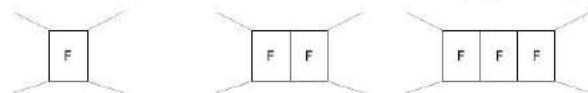

SLIDING PANELS

One or more panels / tracks

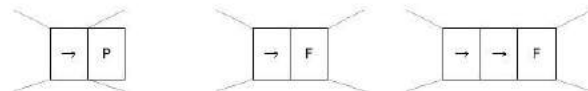

OPEN CORNER SLIDERS

Two or more panels



54 DRAIN

Complete with gutter and sub-frame (right)

Without gutter and sub-frame (center)

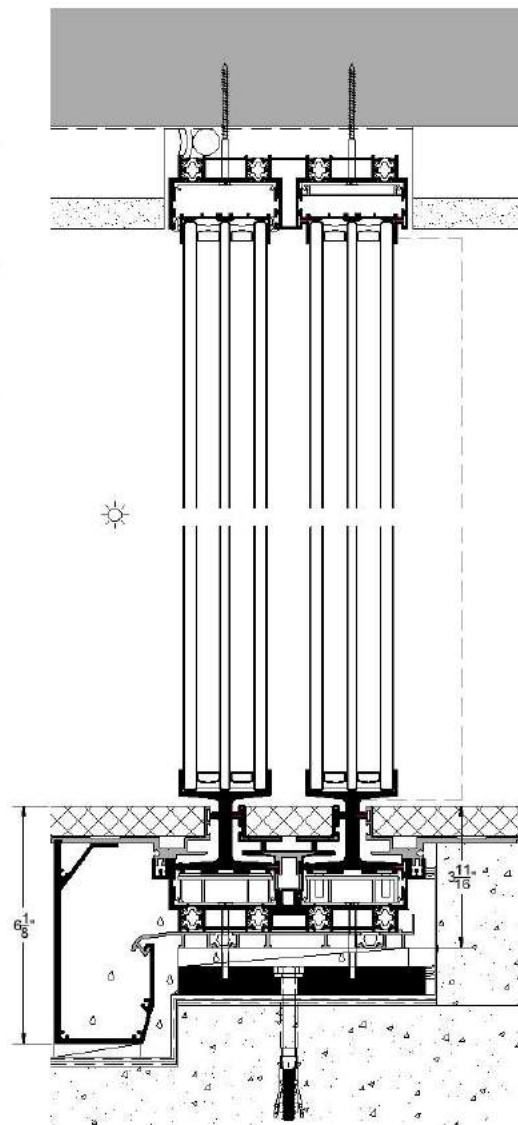
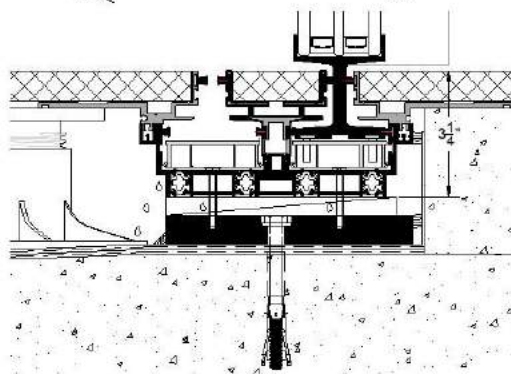



54 FUSION represents the latest evolution of OTIIMA's sliding door platform, offering a hidden header, sill and jamb frames. The FUSION series demonstrates our drive to develop game-changing design capabilities for the architectural community.

The FUSION's exclusive design features a completely redefined, minimalistic frame system by providing the appearance of "floating" glass door panels within the architectural finishes. This series is optimized for 54mm (2-1/8") triple-pane insulated glass. The 54 FUSION can accommodate oversized "jumbo" double-pane glass. Multiple laminated glass options are available when noise reduction and/or impact performance is desired.

OTIIMA is the only company in the world to offer this award-winning system.

Available configurations include fixed windows, multi-panel and sliding windows/doors (including pockets and corner-opening configurations). Door automation can be integrated with all of our sliding doors.

54 FUSION Maximum Panel Size:

Domestic Standard Insulated Glass = 100" x 144"

Domestic Jumbo Insulated Glass = 126" x 268"

European Insulated Glass = 126" x 295"

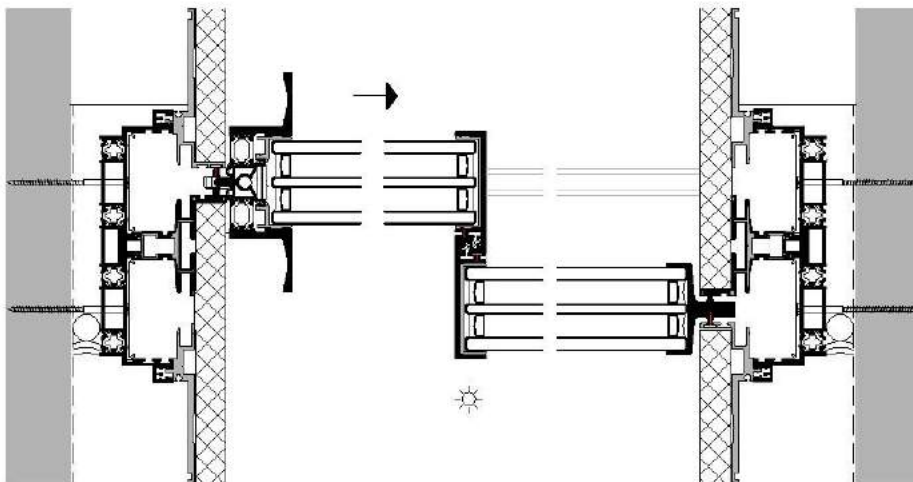

54 FUSION

Complete with gutter and sub-frame (right)

Without gutter and sub-frame (center)

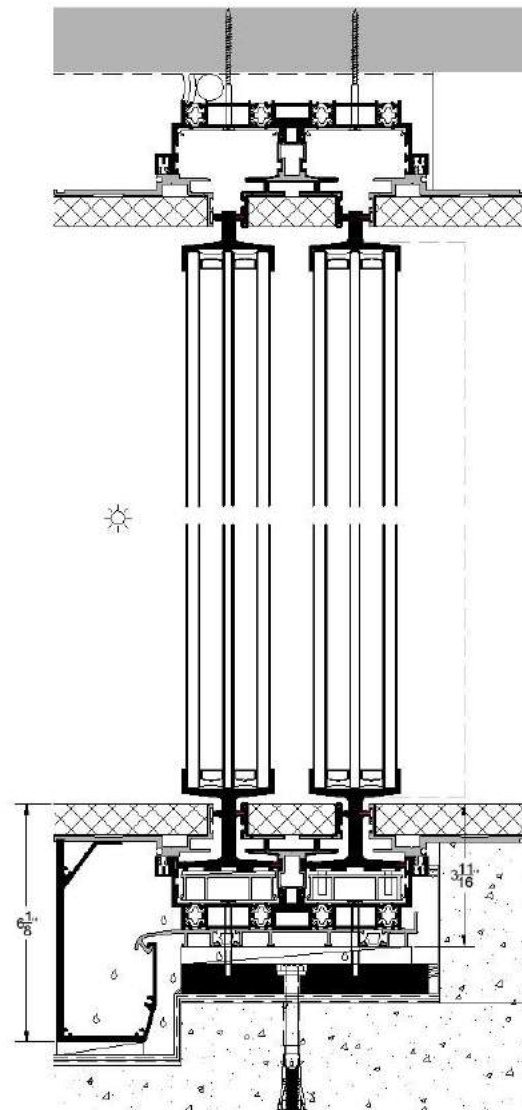
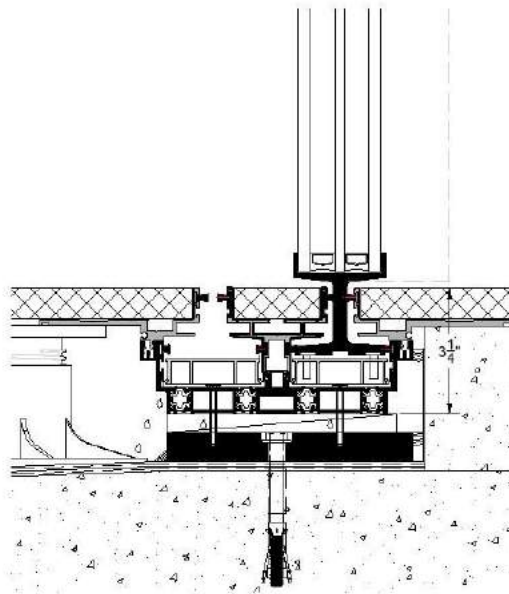



54 PIVOT offers clients a more broad range of operable door types. Often used as an entry door or a wall of doors. The 54 PIVOT uses 54mm (2-1/8") triple-pane insulated glass and can accommodate oversized "jumbo" double-pane glass. Multiple laminated glass options are available when noise reduction and/or impact performance is desired.

Available configurations include single and multi-panel, inward/outward opening and manually operated or automated pivot doors. Each door type can be mullered to fixed windows or window-walls for facade applications.

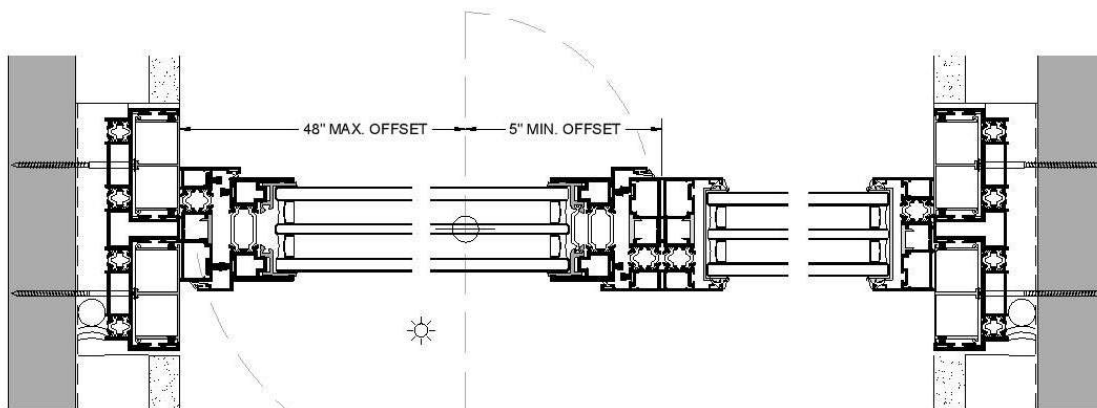

ELECTRONIC LOCKING STILE
Magnetic Lock (12/24VDC)

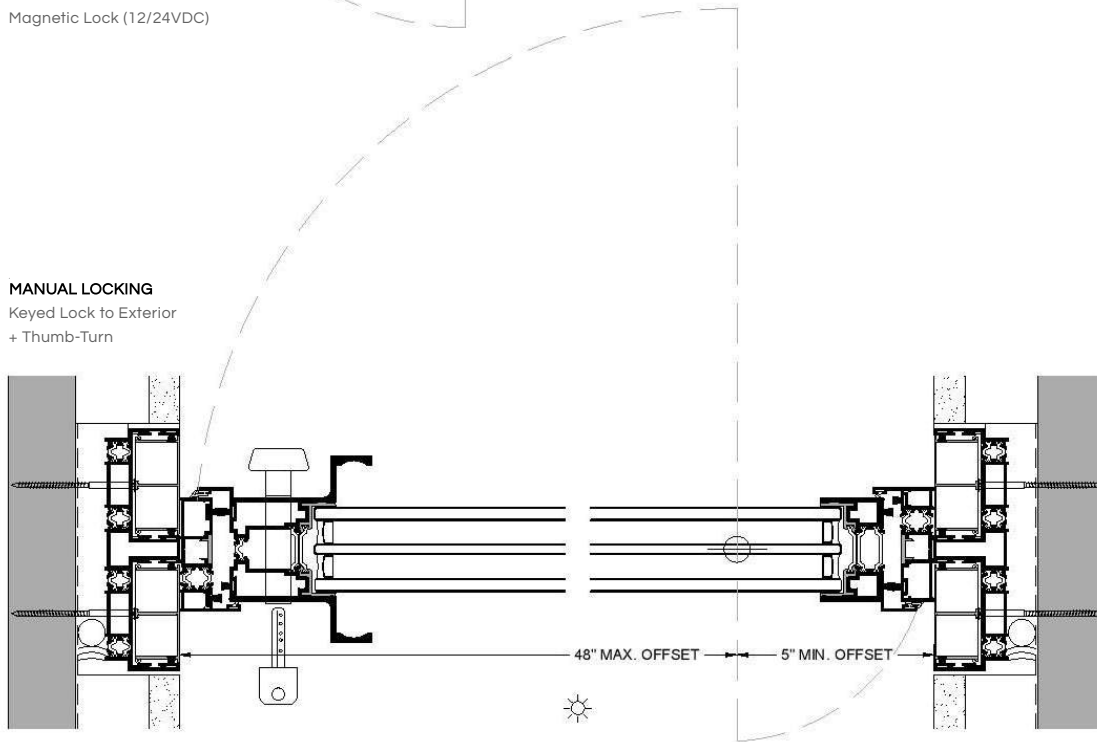

MANUAL LOCKING
Keyed Lock to Exterior
+ Thumb-Turn

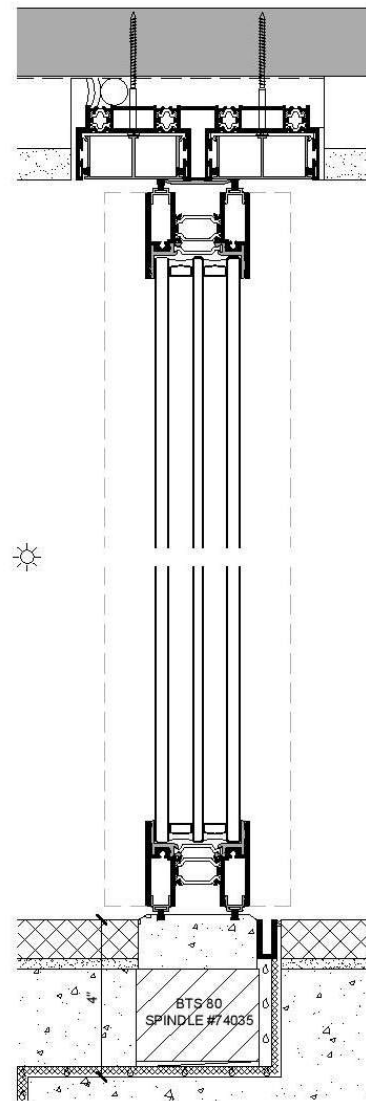

PIVOT



54 SWING is a swing door product for cold climates, utilizing concealed hinges. Offered as both inswing and outswing configurations. This system is most suitable for entry and patio doors. It uses 54mm (2-1/8") triple-pane insulated glass and can also accommodate oversized "jumbo" double-pane glass.

The 54 SWING is available with fixed sidelights or transoms and includes a keyed entry (or thumb-turn only) lock when used with our wider stile design. A narrow stile is available when using an electromagnetic lock.

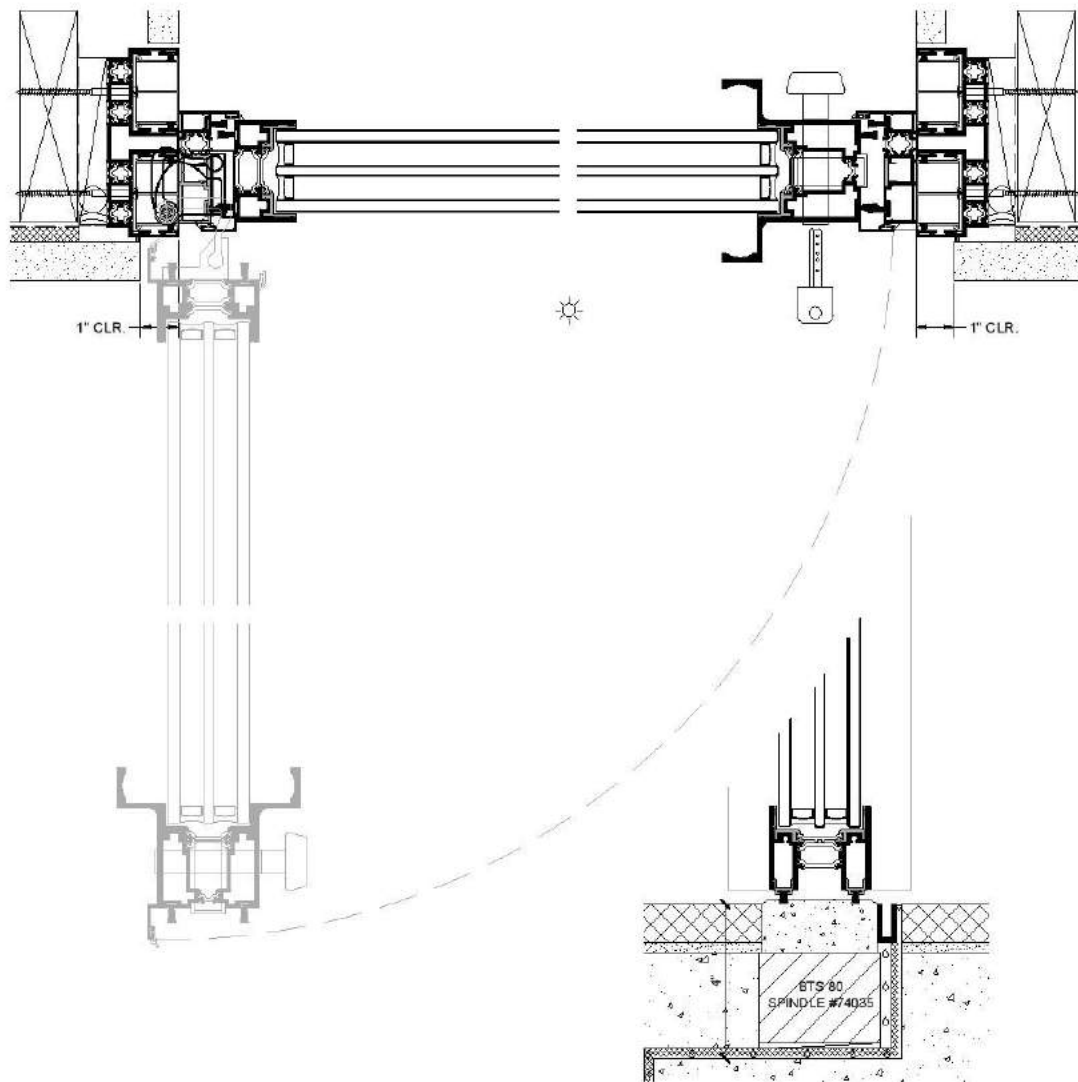

MINIMAL SILL + DRAIN CHANNEL

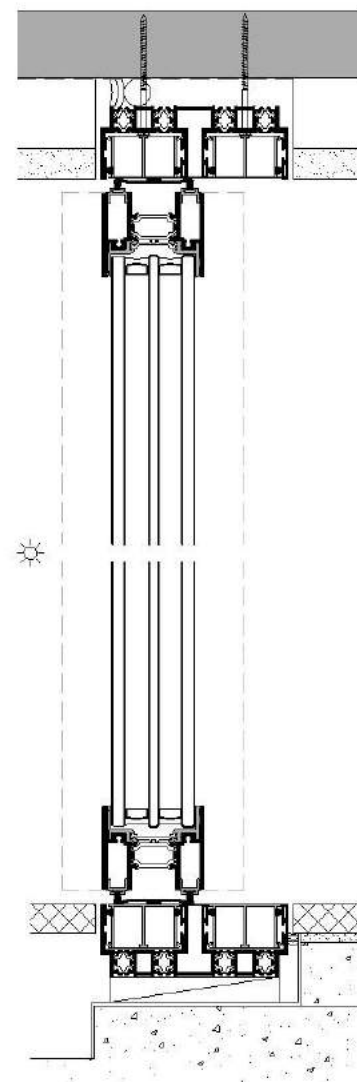

STANDARD SWING DOOR SILL

54 SERIES WINDOWS

54 OPEN

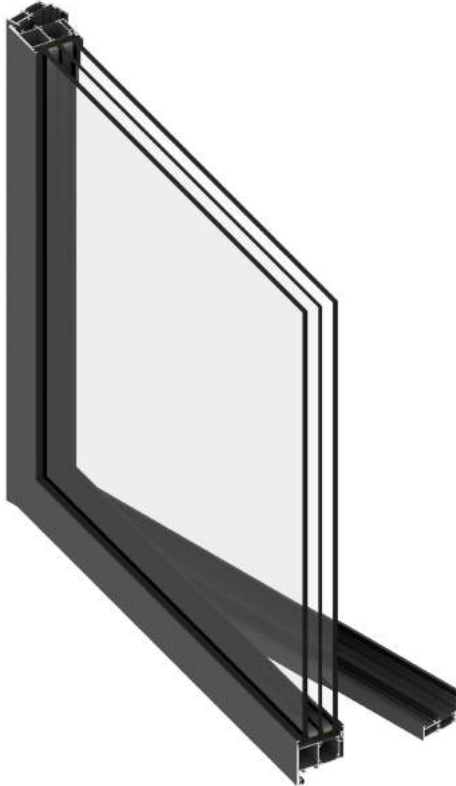

54 OPEN is OTIIMA's cold climate operable window system, offered in both inward and outward opening configurations. It is designed to accept triple-pane glass and offers multi-point locking for increased security. Concealed motorization is available upon request.

Available configurations include inward-opening hopper, tilt and turn windows (dual functionality) and outward-opening awning and casement windows. Each window type can be mullied to fixed windows, other venting windows, or window-walls for facade applications. Curved (radius) and sloped/leaning units are also available upon request.

54 INSWING WINDOWS

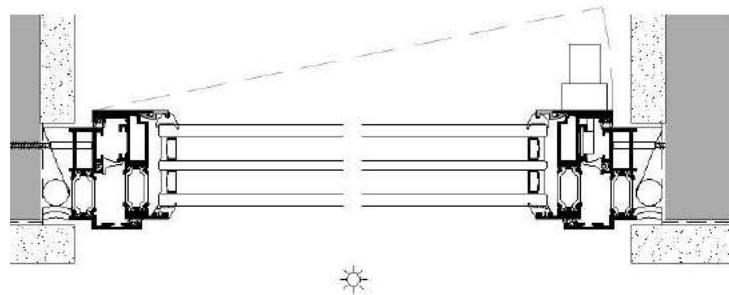
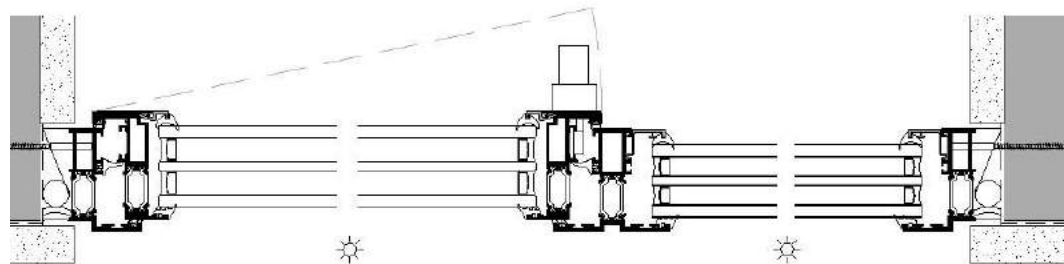

HOPPER WINDOWS

Inward Tilt Windows
and Fixed / Tilt Combos

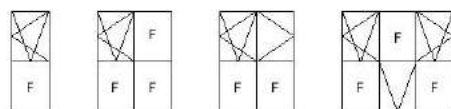
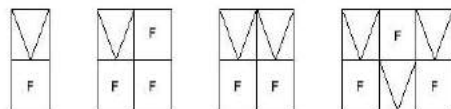

TILT/TURN WINDOWS

Inward Tilt/Swing Windows
and Fixed / Tilt/ Swing

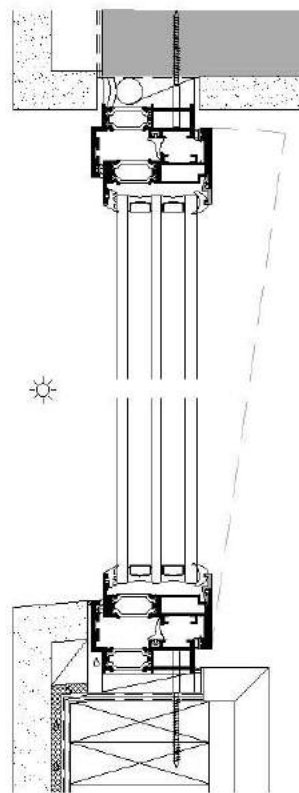
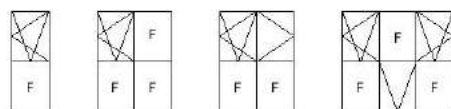

TILT/TURN & HOPPER

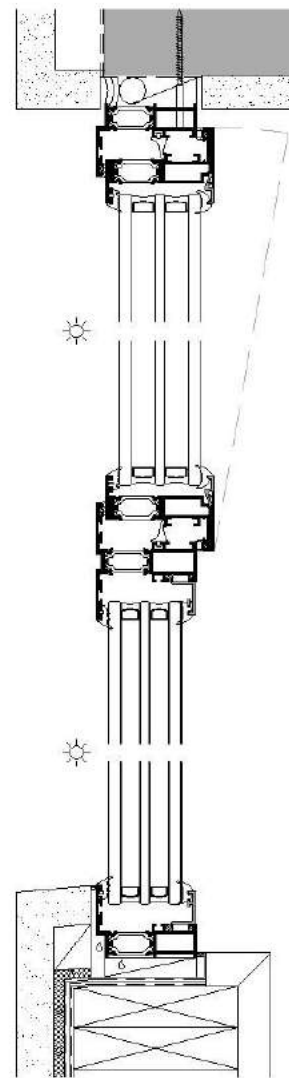

TILT/TURN OVER FIXED

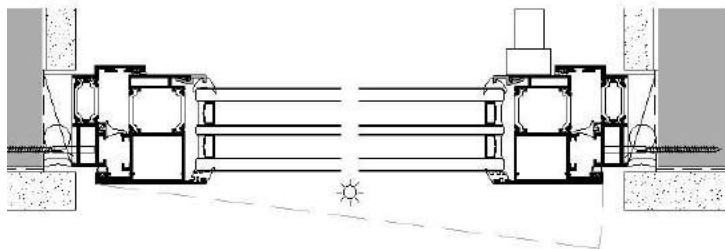
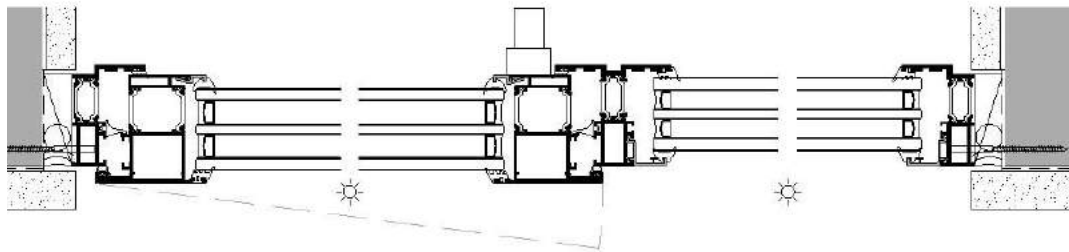

AWNING WINDOWS

+ Fixed Sidelights
Outswing Only

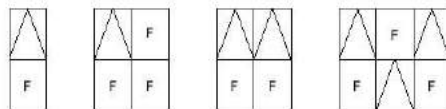

CASEMENT WINDOWS

+ Fixed Sidelights
Outswing Only

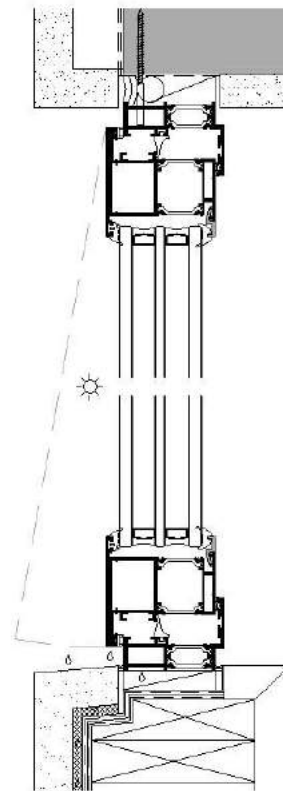
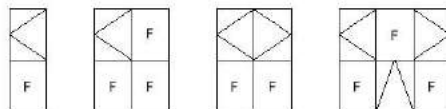

AWNING

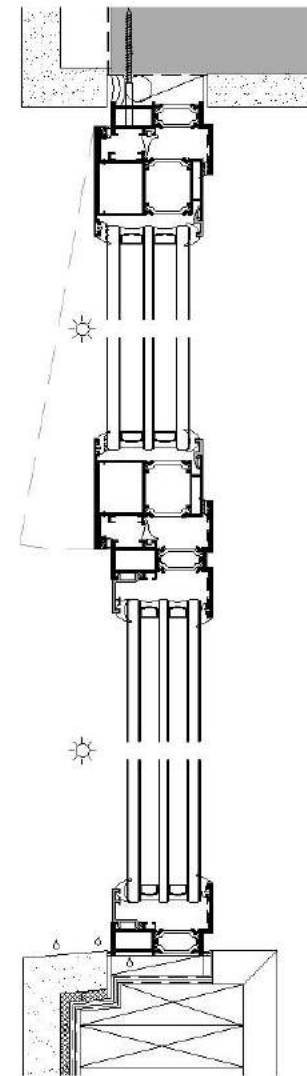

AWNING OVER FIXED

54 FIXED



54 FIXED is OTIIMA's picture window glazing system. This series allows for both interior and exterior glazed options. The FIXED offers a choice of traditional coplanar glass panels with 1-9/16" (40mm) mullions or staggered alternating-plane panels with 13/16" (20mm) mullions.

The 54 Series is specifically designed for cold climates by utilizing 54mm (2-1/8") triple-pane insulated glass. The 54 Series can accommodate oversized "jumbo" double-pane glass. Multiple laminated glass options are available when noise reduction and/or impact performance is desired.

By utilizing the same framework as our door systems, the FIXED has glass sight lines that perfectly match those of OTIIMA's sliding doors.

54 FIXED Maximum Panel Size:

Domestic Standard Insulated Glass = 100" x 144"

Domestic Jumbo Insulated Glass = 126" x 268"

European Insulated Glass = 126" x 295"

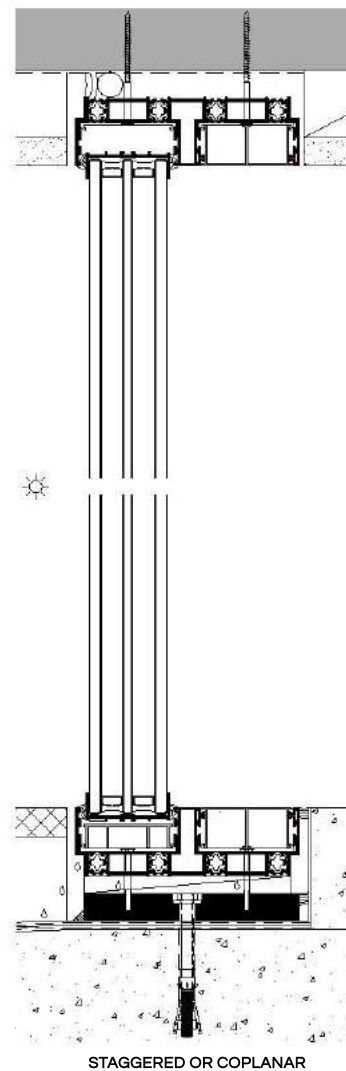
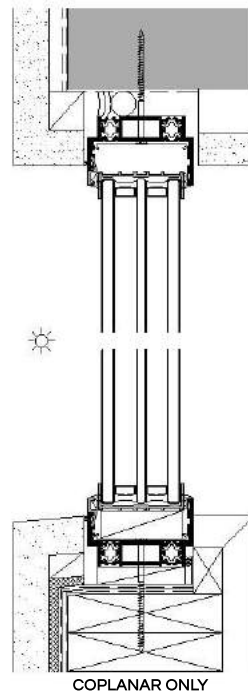
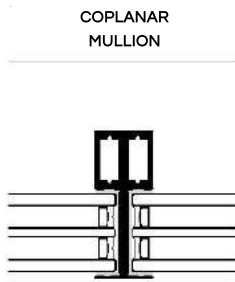
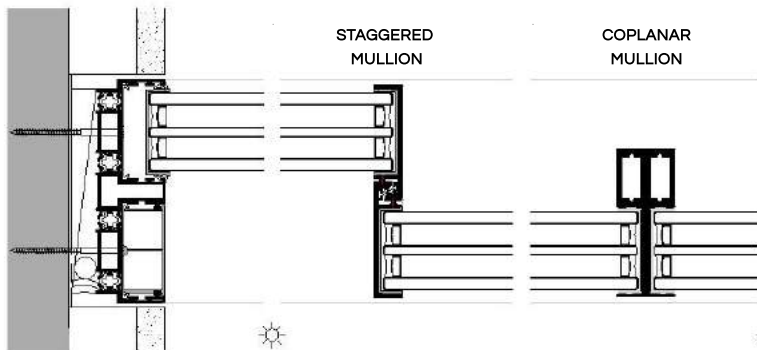
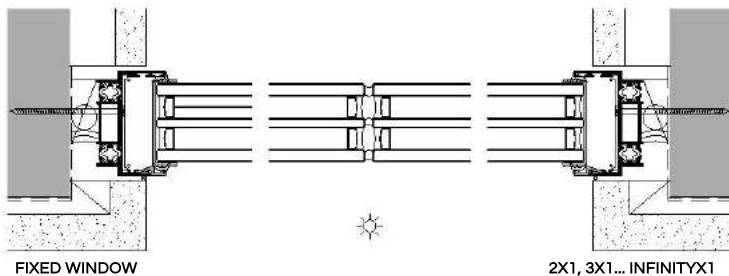
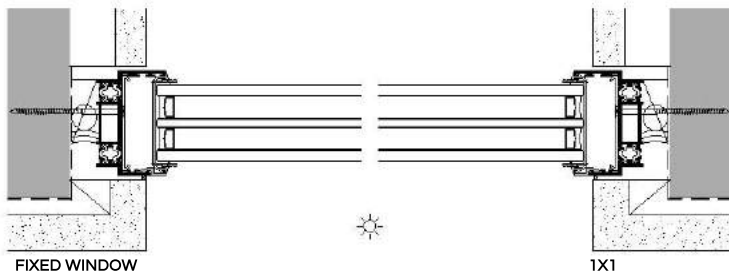



OTIIMA PROFILES

16 SERIES | PROFILE AND HANDLE OPTIONS

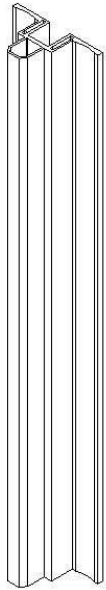

16 CLASSIC
HANDLE 001

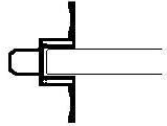

16 CLASSIC
HANDLE 002

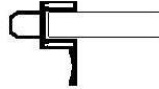

16 CLASSIC
HANDLE 003



16 CLASSIC
MULLION 001

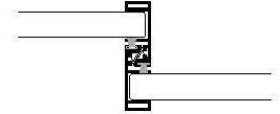

BUTT ALL-GLASS
FIXED CORNER

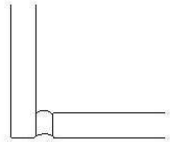

MITERED ALL-GLASS
FIXED CORNER

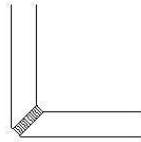

16 FIXED CORNER

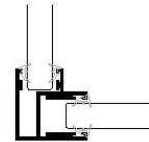

16 OPEN CORNER

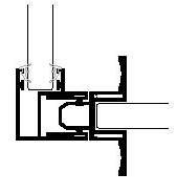

16 FIXED

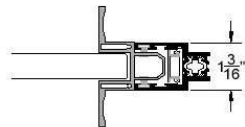

16 SLIDER MONORAIL

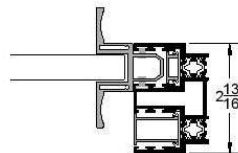

16 SLIDER BI-RAIL

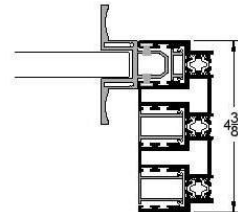

16 SLIDER TRI-RAIL

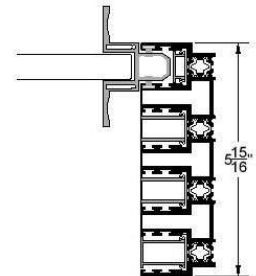

26 FIXED

26 SERIES | LOCKS + HANDLE + INTERLOCKS

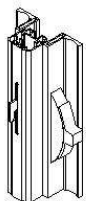
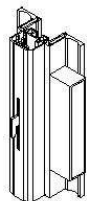

26 PLUS
HANDLE 001

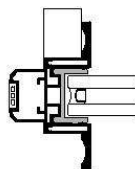

26 PLUS
HANDLE 002

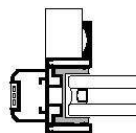

26 PLUS
HANDLE 003

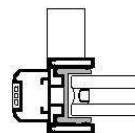

26 PLUS
HANDLE 004

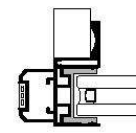

26 PLUS
HANDLE 005

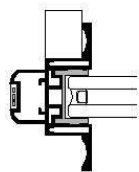
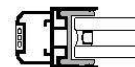

MEYER LOCK

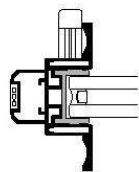

LUNA LOCK

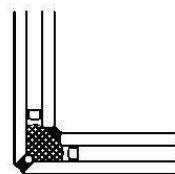

ALL-GLASS
FIXED CORNER

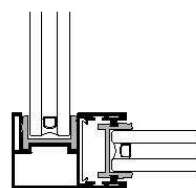

26 FIXED
CORNER

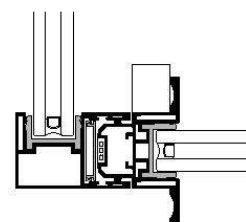

26 OPEN CORNER
+ MEYER LOCK

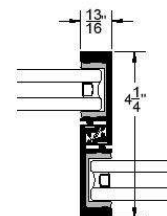

26 STANDARD INTERLOCK

26 SLIDER BI-RAIL

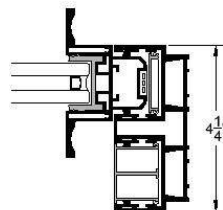

26 SLIDER MONORAIL

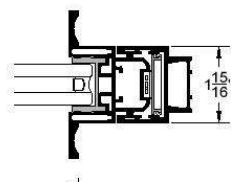

16 SLIDER QUAD-RAIL

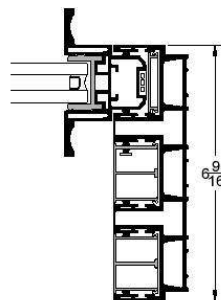
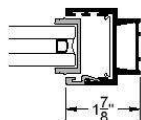

26 SLIDER TRI-RAIL

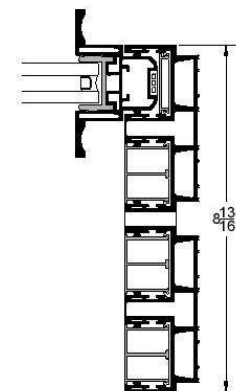

26 SLIDER QUAD-RAIL

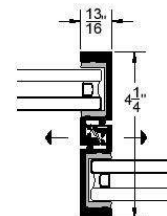

26 REVERSE INTERLOCK

38 SERIES | LOCK & HANDLE OPTIONS

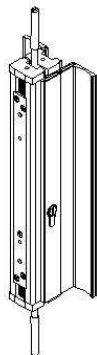
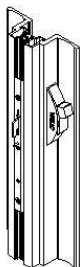

SELF-LOCKING

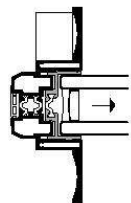
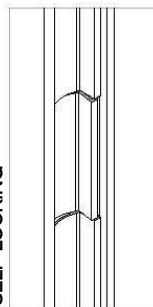

MEYER LOCK

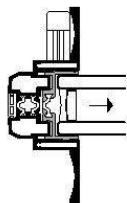

LUNA LOCK

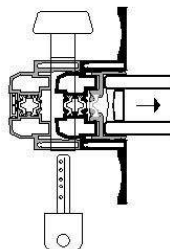

BOLT LOCK

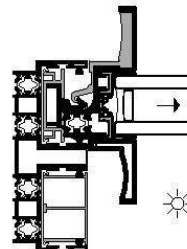

INVISIBLE LOCK

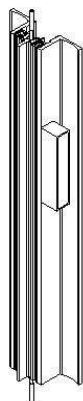

38 FUSION
HANDLE 001

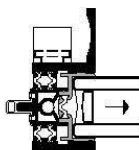
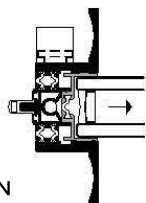

38 FUSION
HANDLE 002

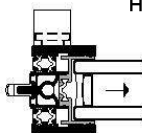

38 FUSION
HANDLE 003

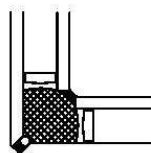

ALL-GLASS
FIXED CORNER

38 CLASSIC
HANDLE 1

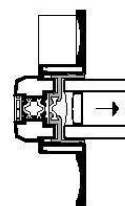

38 CLASSIC
HANDLE 2

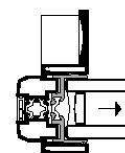

38 CLASSIC
HANDLE 3

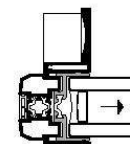
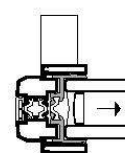

38 CLASSIC
HANDLE 4

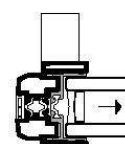

38 CLASSIC
HANDLE 5

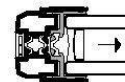

38 CLASSIC
HANDLE 6

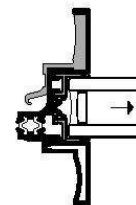

38 INVISIBLE LOCK
HANDLE 7

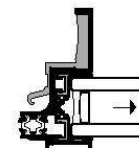

38 INVISIBLE LOCK
HANDLE 8

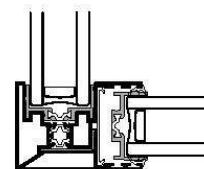

38 FIXED CORNER

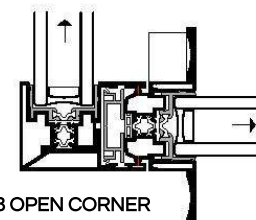

38 OPEN CORNER
+ MEYER LOCK

CORNERS SOLUTIONS

38 SERIES | INTERLOCK MULLIONS

38 CLASSIC
HANDLE 9

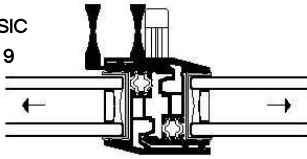

38 CLASSIC
HANDLE 10

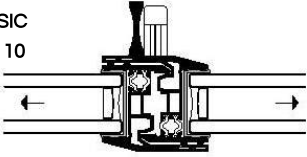

38 INVISIBLE
HANDLE 11

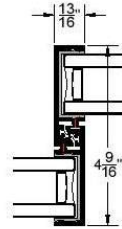
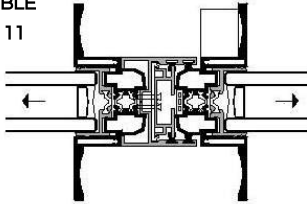

38 ML1

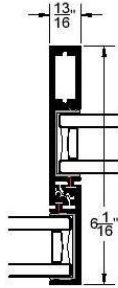

38 ML2

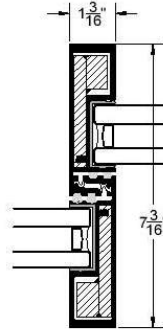

38 ML3
+ STEEL

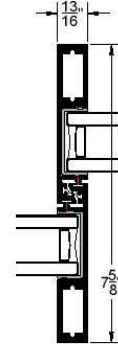

38 ML4

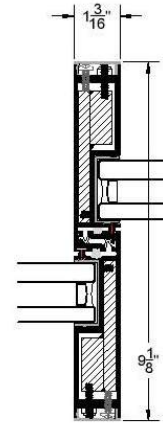

38 ML5
+ STEEL

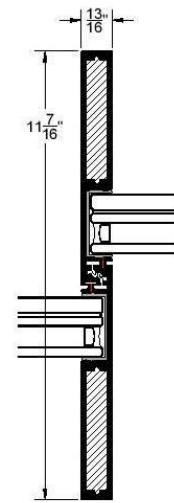

38 ML6
+ STEEL

38 SERIES | REVERSE INTERLOCKS

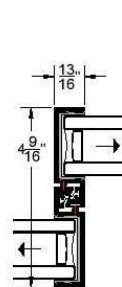

38 RM1

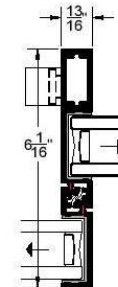

38 RM2

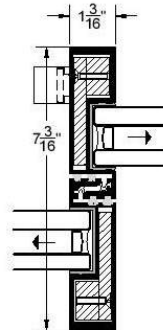

38 RM3
+ STEEL

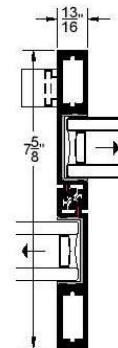

38 RM4

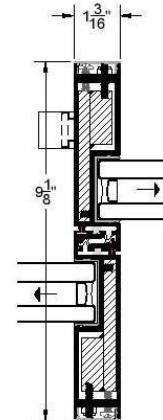

38 RM5
+ STEEL

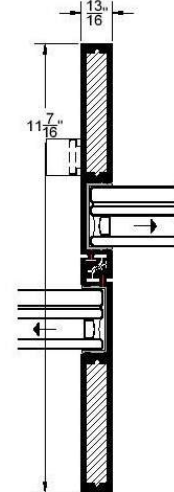

38 RM6
+ STEEL

38 OPEN CORNER
+ KEYED LOCK
+ THUMB-TURN

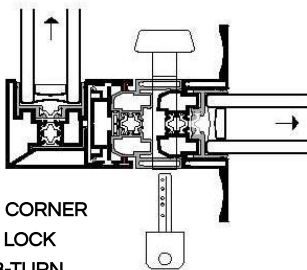

54 SERIES | LOCK & HANDLE OPTIONS

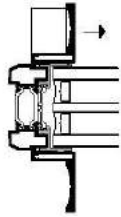
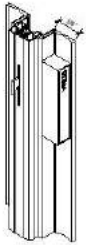

MEYER LOCK

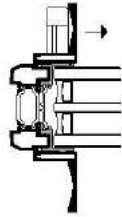

LUNA LOCK

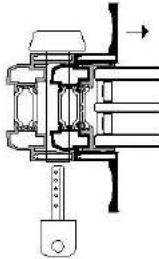

BOLT LOCK

SELF-LOCKING

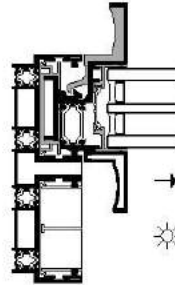
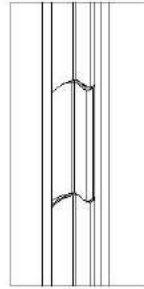

INVISIBLE LOCK



54 FUSION
HANDLE 001

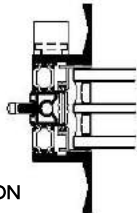

54 FUSION
HANDLE 003

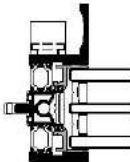

54 FUSION
HANDLE 002

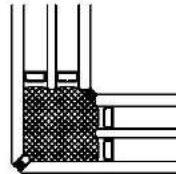
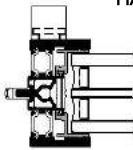

ALL-GLASS
FIXED CORNER

54 CLASSIC
HANDLE 001

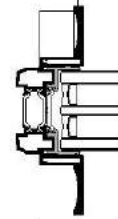

54 CLASSIC
HANDLE 004



54 CLASSIC
HANDLE 002

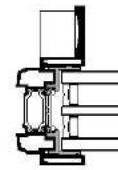

54 CLASSIC
HANDLE 005

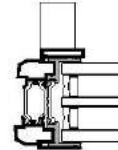

54 CLASSIC
HANDLE 003

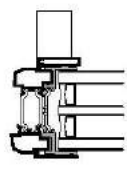

54 CLASSIC
HANDLE 006

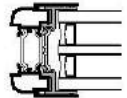

54 INVISIBLE
LOCK HANDLE 1



54 INVISIBLE
LOCK HANDLE 2

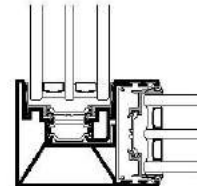
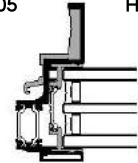

54 FIXED
CORNER

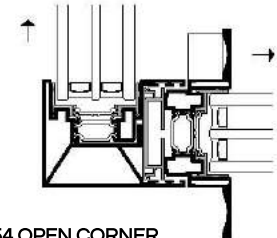

54 OPEN CORNER
+ MEYER LOCK

CORNERS SOLUTIONS

38 CLASSIC
HANDLE 007

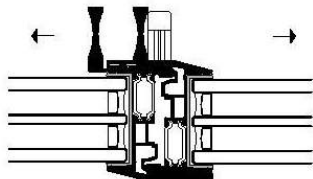

38 CLASSIC
HANDLE 008

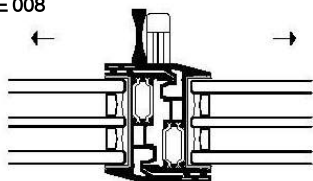

38 CLASSIC
HANDLE 009

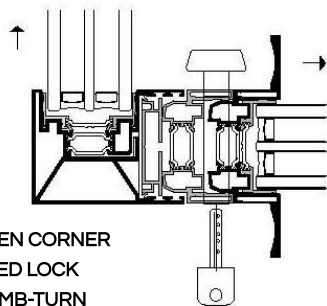
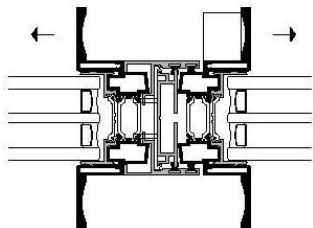

54 OPEN CORNER
+ KEYED LOCK
+ THUMB-TURN

54 SERIES | INTERLOCK MULLIONS

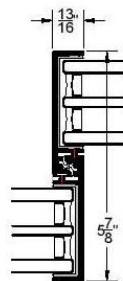

54 ML1

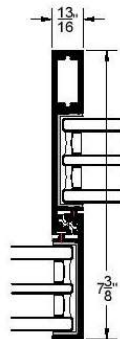

54 ML2

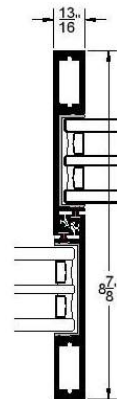

54 ML3

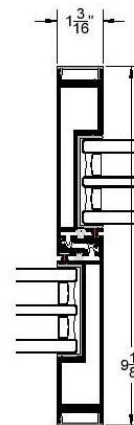

54 ML4

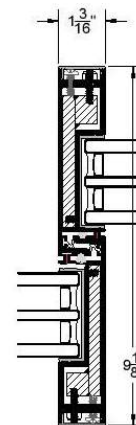

54 ML4
+ STEEL

54 SERIES | REVERSE INTERLOCKS

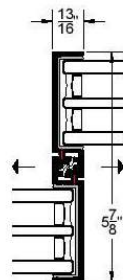

54 RM1

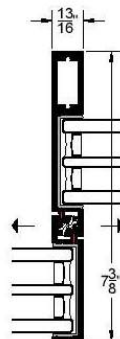

54 RM2

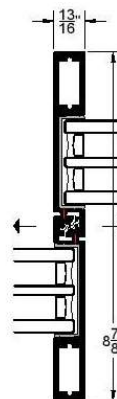

54 RM3

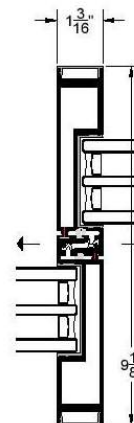

54 RM4

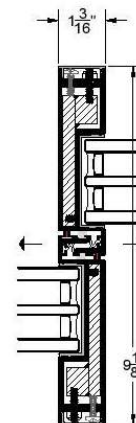

54 RM4
+ STEEL



OTIIMA LINEUP

OTIIMA LINEUP

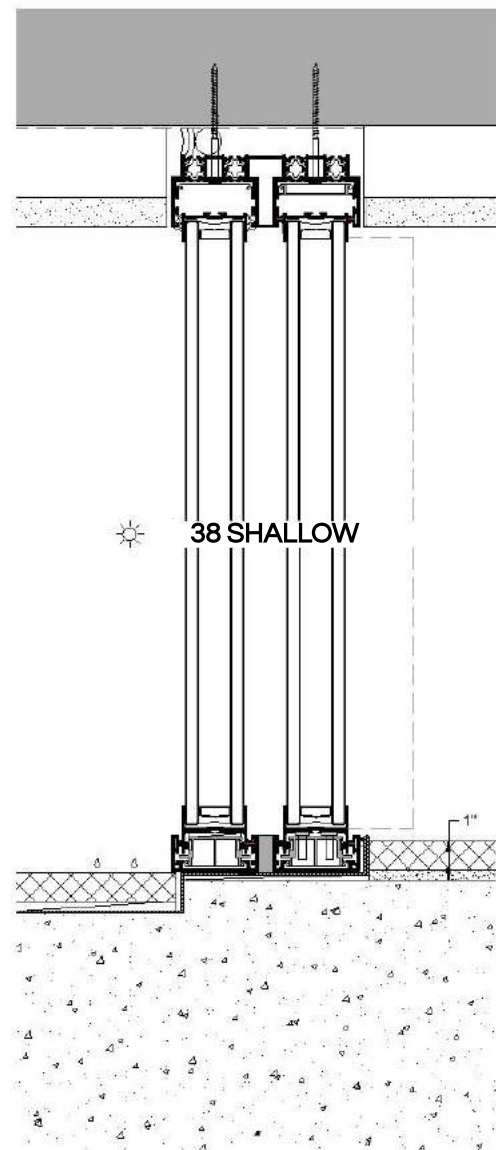
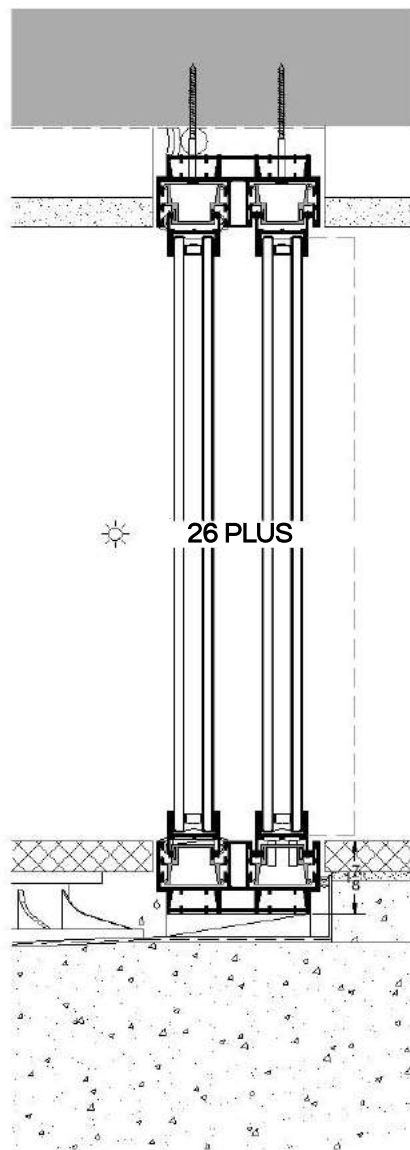
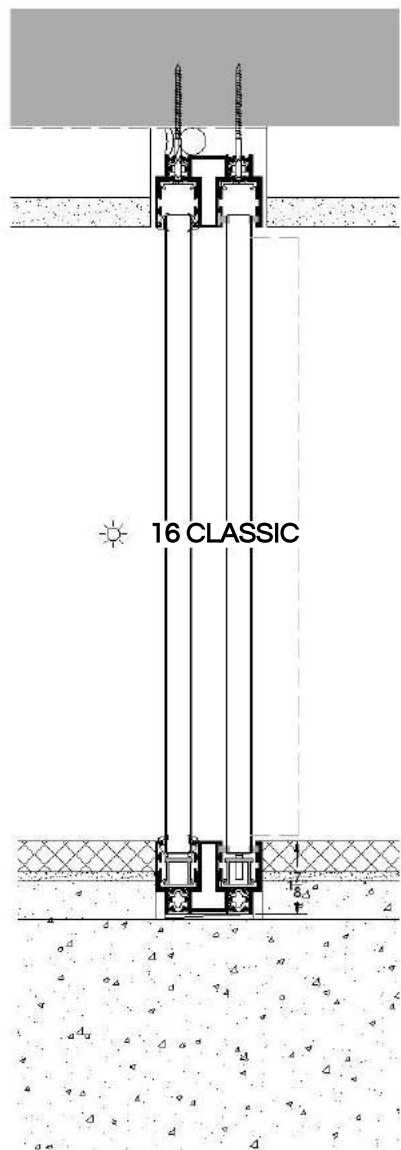

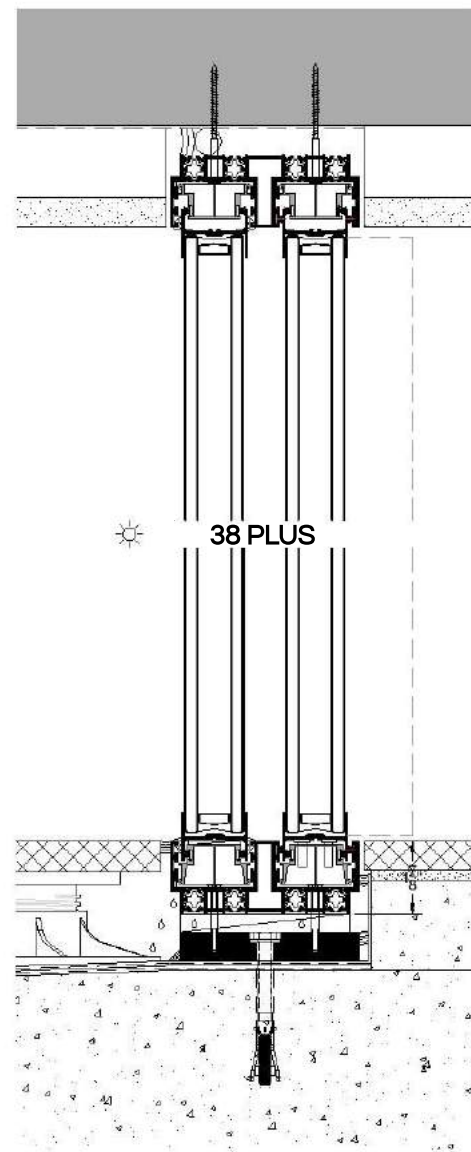
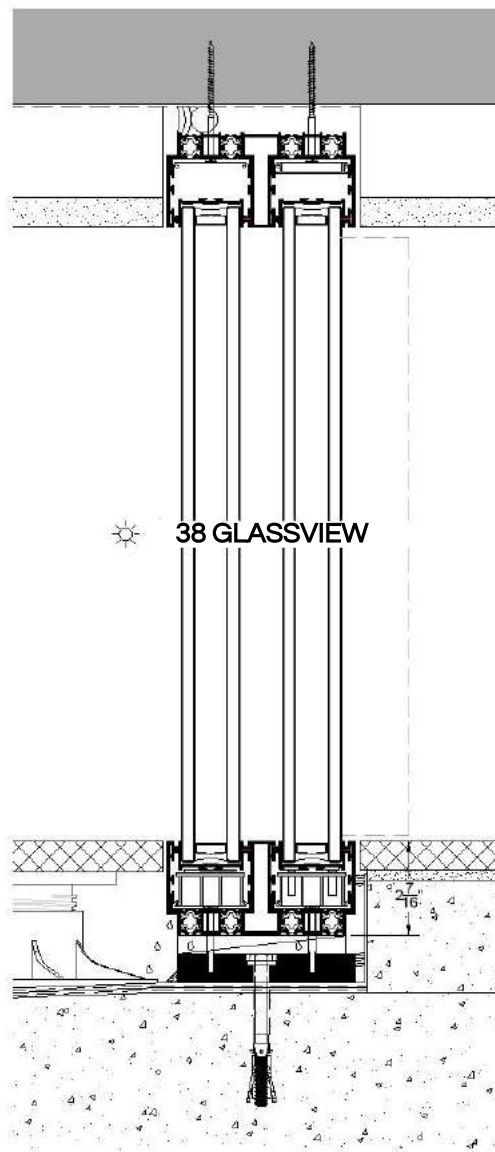
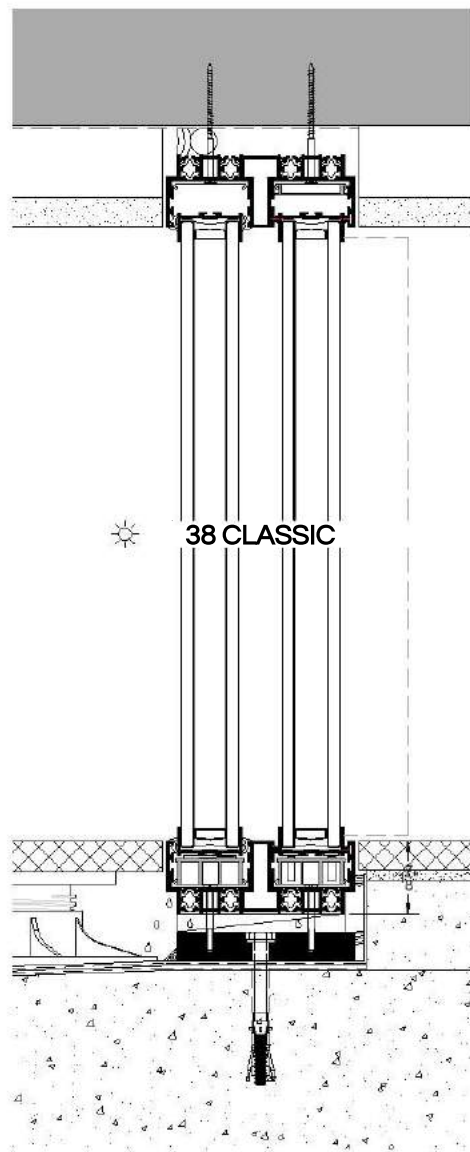

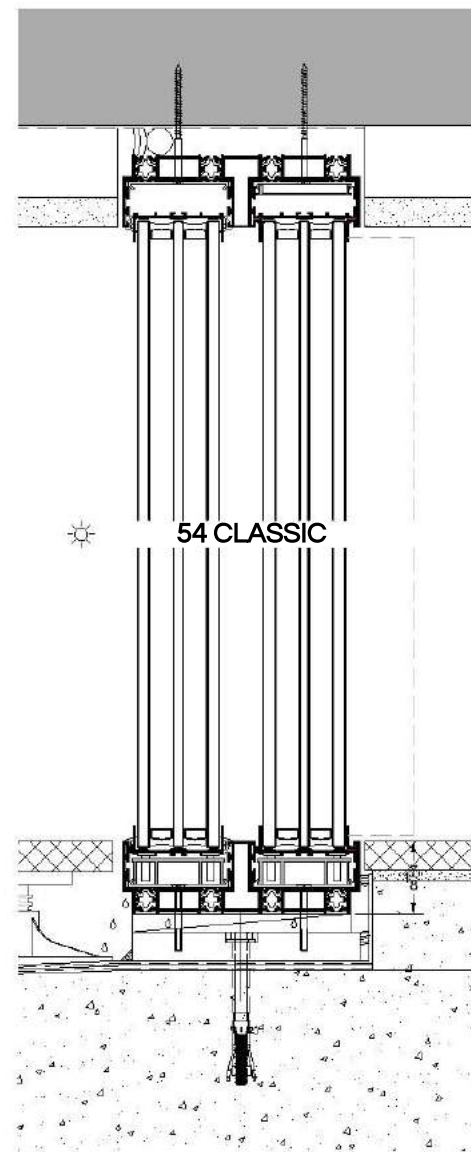
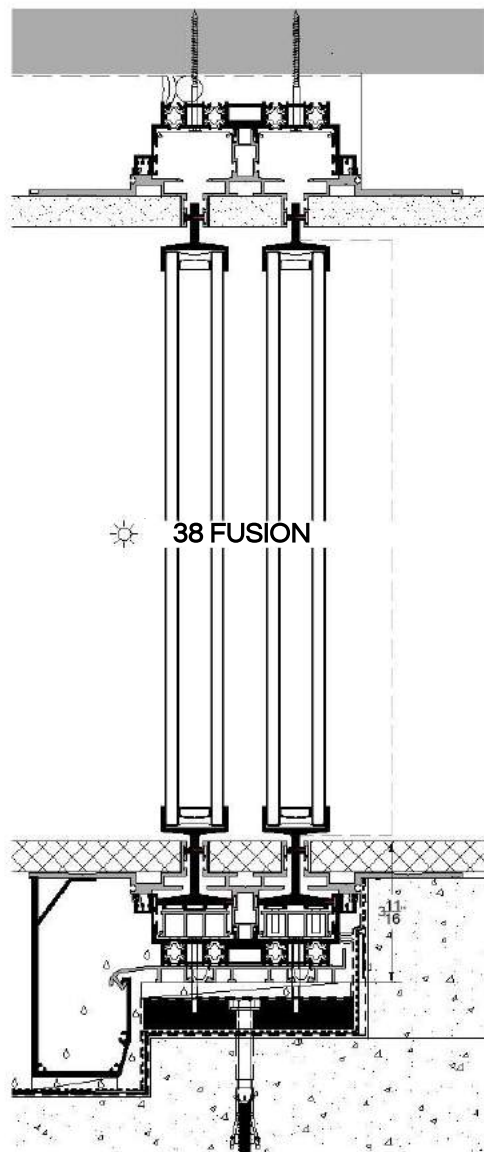
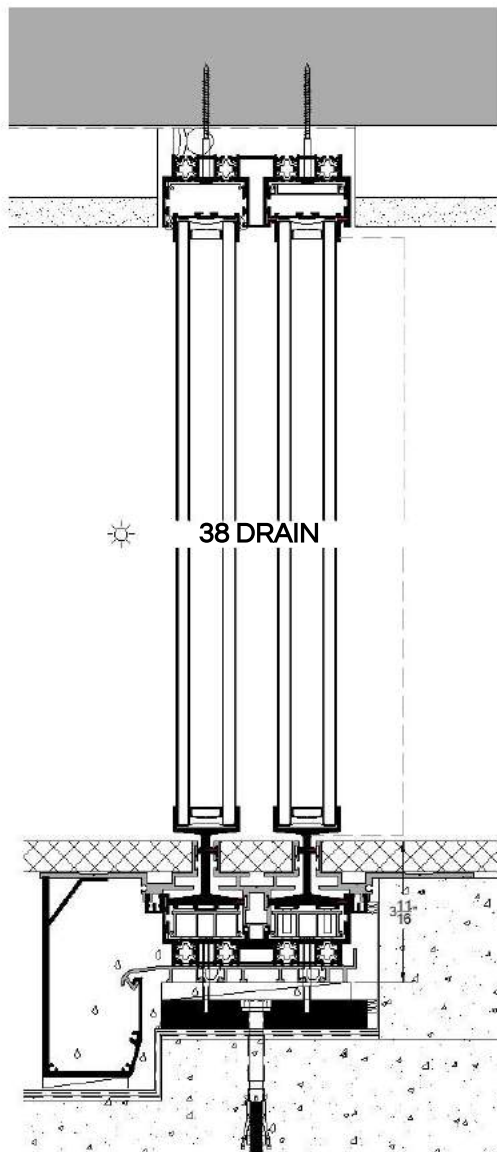

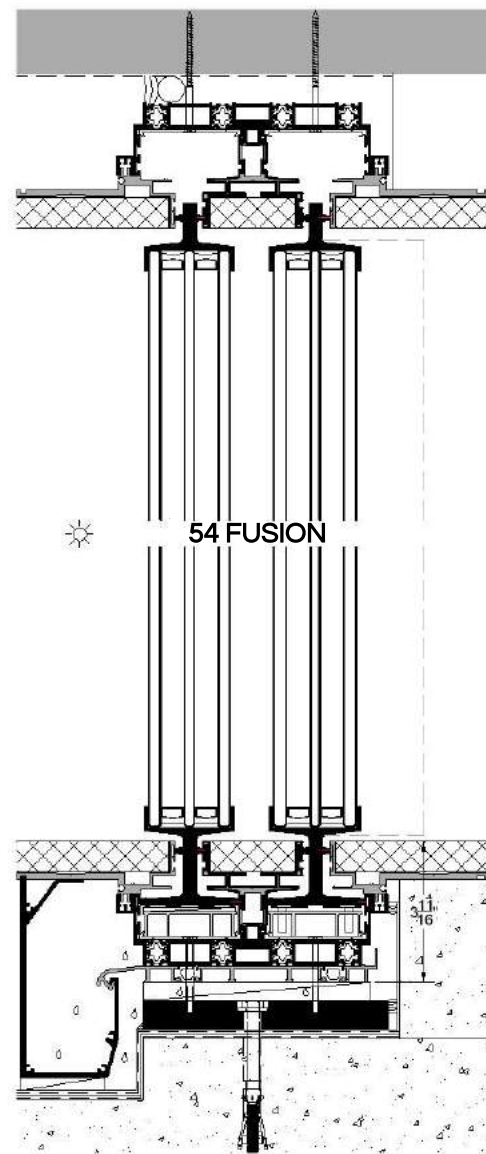
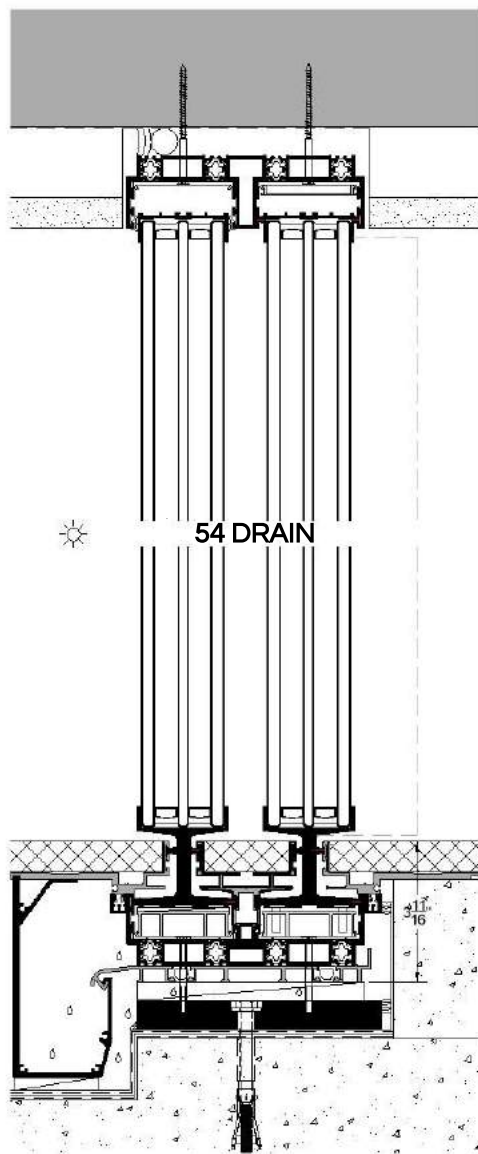
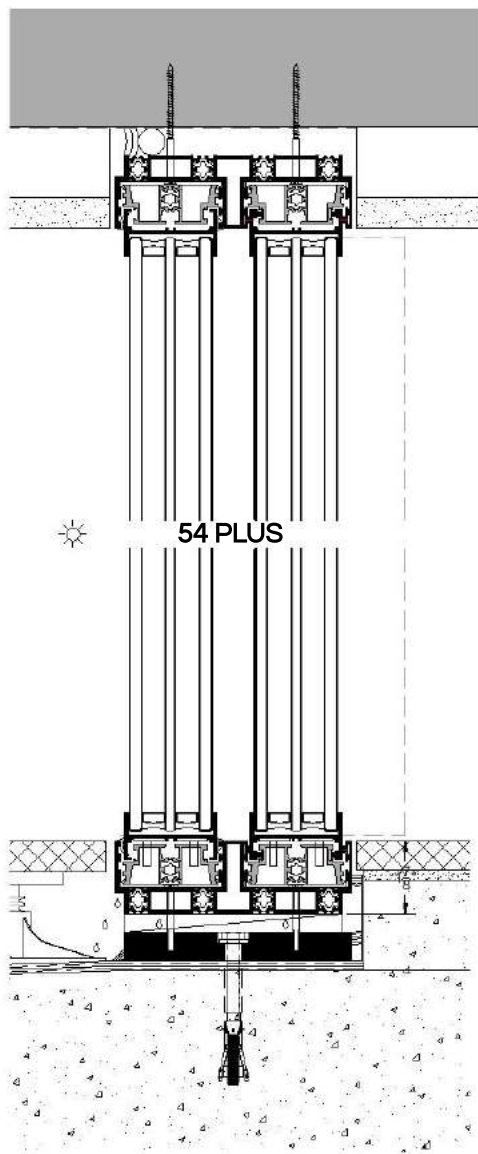

OTIIMA LINEUP



OTIIMA

MUCH MORE THAN A WINDOW

LOS ANGELES

310.844.1199

WWW.OTIIMAUSA.COM

INFO@OTIIMAUSA.COM